

Lubrication Fittings & Accessories:

Introduction	2
Threaded Fittings	4
Spin Drive Fittings	7
Drive Type Fittings	8
Stainless Steel Fittings	9
Special Purpose Fittings	10
Elbows and Plugs	11
Design Tips	12
Remote Lube Fitting Systems	14
Carton Quantities	20

Installation Components:

Tubing	23
Clamps and Screws	24
Heavy Duty Tube Fittings	25
Standard Duty Tube Fittings	26
Threaded Sleeve Tube Fittings	28
Snap-On Coupler Tube Fittings	29
Tubing Adapters	30
Supply Line and Material Hose	31
Feed Line Hose	32
Bulk Feed Line Hose and Fittings	33
Kits for Hose Repair	34
Pipe Fittings	35
Accessories	38
AirCare Air Preparation Systems	41
Air Control and Accessories	51
Decimal Equivalents	53
Numerical Index	54

Lubrication Fittings & Accessories

Introduction



A Lincoln lubrication fitting can be used for all of your lubrication needs. Our fittings are used in the automobile, agricultural, marine, truck, construction equipment, and machine manufacturing industries.

Lincoln offers a full line of lubrication fittings to meet the manufacturing requirements of today's industries. Our line consists of common threaded, thread-forming, drive-type, stainless steel, pressure relief, standard button head, and vent fittings.



Common Threaded Fitting



Thread Forming Fitting



Drive Type Fitting



Stainless Steel Fitting



Pressure Relief Fitting



Standard Button Head Fitting



Vent Fitting

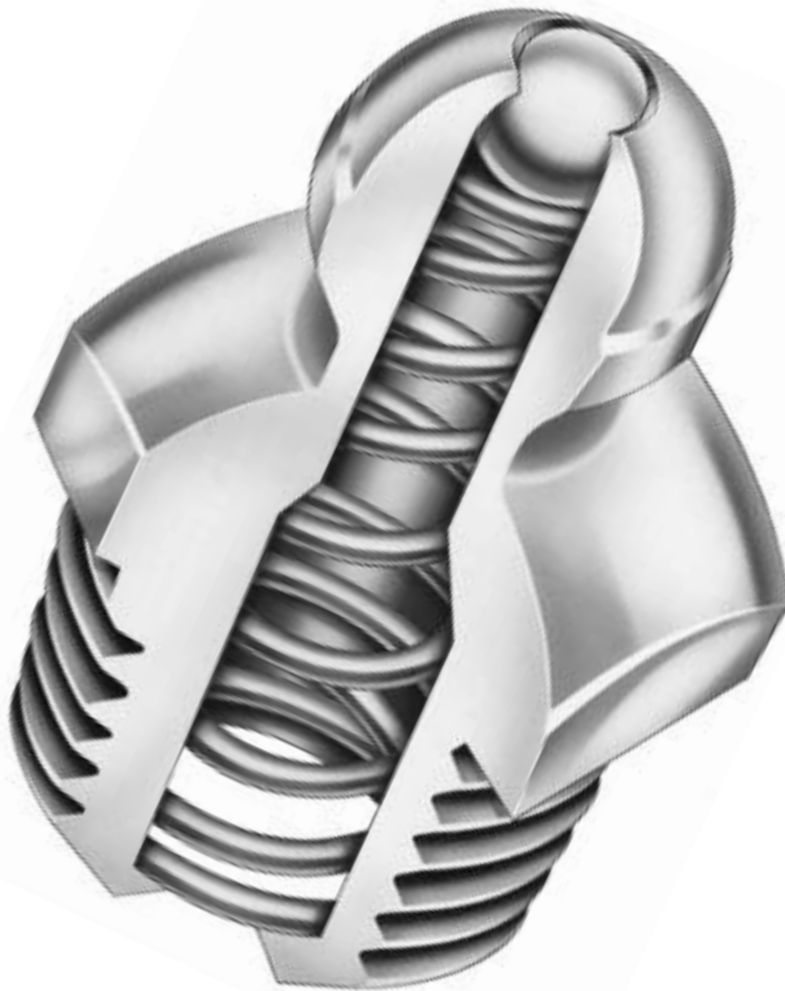

The ball check in the head of the fitting prevents dirt and grit from getting into the bearing. The fittings can be wiped clean without forcing foreign material into the fitting and the bearing. The true spherical contour of the fitting head provides a natural ball and socket joint between the fitting head and any commercial hydraulic coupler for a wide angularity of contact, and a tight metal-to-metal seal. The internal spring on the fittings is tempered with music wire, coiled so that it cannot be compressed to restrict the flow of heavy lubricants, or forced out of the body under normal pressures. The fittings have a specially formed lip at the fitting base that locks the spring and ball securely in place.

Remote Lube Fitting Systems:
To easily reach hidden, inaccessible or hazardous bearings

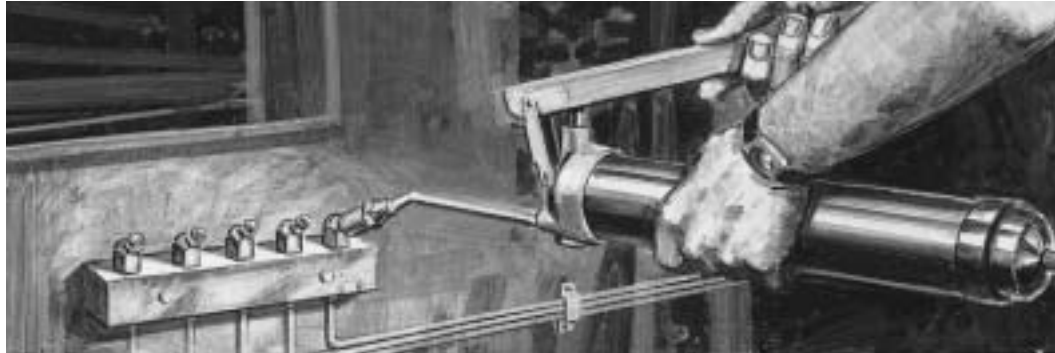

Hard-to-reach lubrication fittings present a major maintenance problem for the proper care of all types of machinery. Hidden or guarded lubrication fittings can lead to production downtime, higher operating and maintenance costs and the risk of personal injury to operators and employees—all directly traceable to poor lubrication fitting access.

How do you eliminate these problems?

Lincoln's Remote Lube Fitting Systems

Benefits

- Easy access to lubrication fittings
- Easier, quicker and safer lubrication
- Assures that all bearings are lubricated
- Bearings can be safely lubricated while machine is operating
- Reaches hidden, inaccessible or hazardous bearings

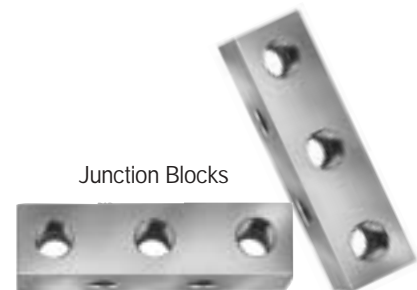

Lubrication Fittings & Accessories

Threaded Fittings



All of the straight grease fittings are heat treated. On the angle fittings, the ball check end or the greasing end is heat treated. The spin drive and drive type angle fittings are entirely heat treated. All fittings are zinc plated and have a supplemental coating of chromate.



No. 5010
*No. 5010-1
1/4" -28 Taper Th'd.
(SAE-LT)



No. 5527
1/4" -28 U.N.F.
2A Th'd.



No. 240646
1/4" -28 Taper Th'd.
(SAE-LT)



No. 5013
1/4" -28 Taper Th'd.
(SAE-LT)



No. 5014
1/4" -28 Taper Th'd.
(SAE-LT)



No. 5210
1/4" -28 Taper Th'd.
(SAE-LT)



No. 5410
1/4" -28 Taper Th'd.
(SAE-LT)

1/4" - 28 Thread (Straight & Taper)

This type of thread is used mostly on cars and light trucks. The (SAE-LT) is a thread that conforms to the Society of Automotive Engineers lubrication fittings thread specification.

Model No.	A in./mm	B in./mm	C in./mm	D in./mm	E	F in./mm	G in./mm
5527	31/64 / 12.3	9/64 / 3.6	9/32 / 7.1	.250 / 6.4	—	—	—
240646	31/64 / 12.3	5/32 / 4.0	5/16 / 7.9	.255 / 6.5	—	—	—
5010	17/32 / 13.5	3/16 / 4.8	5/16 / 7.9	.260 / 6.6	—	—	—
*5010-1	35/64 / 13.9	7/32 / 5.6	5/16 / 7.9	.260 / 6.6	—	—	—
5013	43/64 / 17.1	11/32 / 8.7	5/16 / 7.9	.260 / 6.6	—	—	—
5014	15/16 / 23.8	39/64 / 15.5	5/16 / 7.9	.260 / 6.6	—	—	—
5210	13/16 / 20.6	13/64 / 5.2	3/8 / 9.5	.260 / 6.6	45°	37/64 / 14.7	25/64 / 9.9
5410	3/4 / 19.1	3/16 / 4.8	3/8 / 9.5	.260 / 6.6	90°	21/32 / 16.7	15/32 / 11.9

* Not illustrated. Same as No. 5010 but without Ball Check.

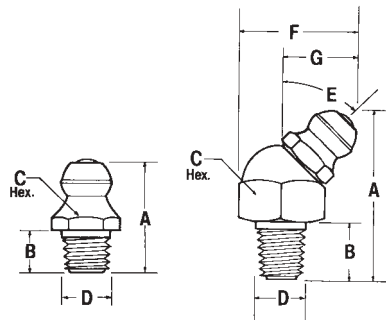

1/8" Pipe Thread

The 1/8" pipe threaded fittings are constructed for additional strength. This type of fitting is popular for use in the construction and agricultural industry and large industrial machinery.



No. 5000
*No. 5000-1
1/8" P.T.F. Spec.
Extra Short



No. 5003
1/8" P.T.F.
Spec. Short



No. 5009
1/8" P.T.F.
Spec. Short



No. 5505
1/8" N.P.T.F.

Model No.	A in. / mm	B in. / mm	C in. / mm	D in. / mm	E	F in. / mm	G in. / mm
5000	4 1/64 / 16.3	9/32 / 7.1	7/16 / 11.1	.400 / 10.2	—	—	—
*5000-1	2 1/32 / 16.7	5/16 / 7.9	7/16 / 11.1	.400 / 10.2	—	—	—
5003	1 1/4 / 31.8	3/4 / 19.1	7/16 / 11.1	.400 / 10.2	—	—	—
5009	2 5/8 / 66.7	2 5/32 / 54.8	7/16 / 11.1	.400 / 10.2	—	—	—
5505	1 / 25.4	5/16 / 7.9	1/2 / 12.7	.480 / 12.2	—	—	—
5200	7/8 / 22.2	9/32 / 7.1	7/16 / 11.1	.400 / 10.2	45°	4 1/64 / 16.3	2 7/64 / 10.7
5300	7/8 / 22.2	9/32 / 7.1	7/16 / 11.1	.400 / 10.2	65°	2 3/32 / 18.3	1/2 / 12.7
5308	1 3/16 / 30.2	9/16 / 14.3	7/16 / 11.1	.400 / 10.2	65°	2 3/32 / 18.3	1/2 / 12.7
5400	2 7/32 / 21.4	9/32 / 7.1	7/16 / 11.1	.400 / 10.2	90°	4 7/64 / 18.7	1/2 / 12.7

* Not illustrated. Same as No. 5000 but without Ball Check.



No. 5200
1/8" P.T.F.
Spec. Short



No. 5300
1/8" P.T.F.
Spec. Short



No. 5308
1/8" P.T.F.
Spec. Short



No. 5400
1/8" P.T.F.
Spec. Short

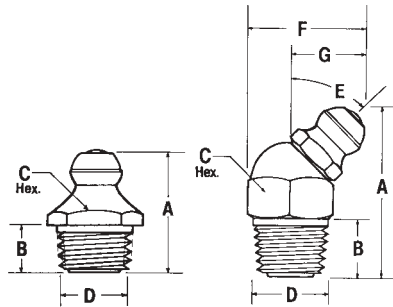



No. 5050
1/4" N.P.T.

1/4" Pipe Thread

Model No.	A in. / mm	B in. / mm	C in. / mm	D in. / mm	E	F in. / mm	G in. / mm
5050	53/64 / 21.0	3/8 / 9.5	9/16 / 14.3	.535 / 13.6	—	—	—
5350	1 1/32 / 26.2	3/8 / 9.5	9/16 / 14.3	.535 / 13.6	65°	13/16 / 20.6	17/32 / 13.5



No. 5350
1/4" N.P.T.F. Spec.
Extra Short

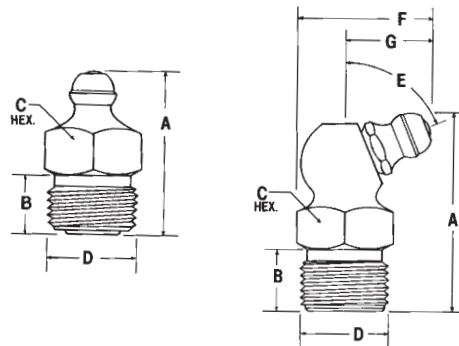

No. 5181
10 mm x 1



No. 5182
10 mm x 1



No. 5183
10 mm x 1

Metric Fittings—6mm, 8mm, 10mm

Model No.	A in. / mm	B in. / mm	C	D	E	F in. / mm	G in. / mm
*5175	5/8 / 15.9	7/32 / 5.6	7mm	6mm x 1	—	—	—
*5176	13/16 / 20.6	7/32 / 5.6	9mm		45°	37/64 / 14.7	25/64 / 9.9
*5177	45/64 / 17.9	7/32 / 5.6	9mm		90°	3/4 / 19.1	9/16 / 14.3
*5178	21/32 / 16.7	7/32 / 5.6	9mm	8mm x 1	—	—	—
*5179	13/16 / 20.6	7/32 / 5.6	9mm		45°	37/64 / 14.7	25/64 / 9.9
*5180	45/64 / 17.9	7/32 / 5.6	9mm		90°	3/4 / 19.1	9/16 / 14.3
5181	45/64 / 17.9	7/32 / 5.6	11mm	10mm x 1	—	—	—
5182	13/16 / 20.6	7/32 / 5.6	11mm		45°	41/64 / 16.3	27/64 / 10.7
5183	45/64 / 17.9	7/32 / 5.6	11mm		90°	13/16 / 20.6	39/64 / 15.5

* Not illustrated.

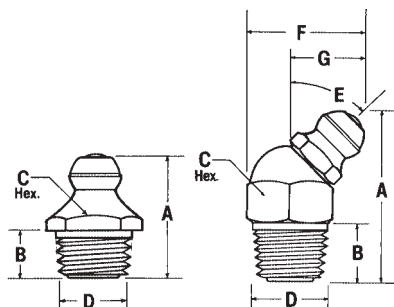

Spin Drive

Spin Drive (thread forming) fittings have special tapered drive threads for fast production line installation in untapped holes to save tapping cost. Spinning into the hole with a power wrench provides the most effective installation. Installation torque limits, to avoid stripping, should be established by test in the type of material in which production fittings are to be installed. Installation force causes a rearrangement of mating material to conform with the fitting thread contour creating a leak-tight permanent seal. Not recommended for heat treated parts. Fitting threads are heat treated to Rockwell 83-89 on the 15N scale. The body portion for this type of fitting thread is a yellow chromate finish for identification from the standard fitting thread.

For field servicing, Spin Drive fittings may be replaced by any standard fitting having the same thread size or another Spin Drive fitting.



No. 205010

1/4" -28 Spec. Taper Drive Th'd.



No. 205000

1/8" Pipe-Special Taper Drive Th'd.



No. 247235

1/8" Pipe-Special Taper Drive Th'd.



No. 205210

1/4" -28 Spec. Taper Drive Th'd.



No. 205200

1/8" Pipe-Special Taper Drive Th'd.



No. 205410

1/4" -28 Spec. Taper Drive Th'd.



No. 205400

1/8" Pipe-Special Taper Drive Th'd.

Spin Drive Fittings

Model No.	A in. / mm	B in. / mm	C in. / mm	D in. / mm	E	F in. / mm	G in. / mm
205010	35/64 / 13.9	13/64 / 5.2	5/16 / 7.9	.256 / 6.5	—	—	—
205000	5/8 / 15.9	1/4 / 6.4	7/16 / 11.1	.396 / 10.1	—	—	—
247235	45/64 / 17.9	21/64 / 8.3	7/16 / 11.1	.400 / 10.2	—	—	—
205210	51/64 / 20.2	3/16 / 4.8	3/8 / 9.5	.256 / 6.5	45°	37/64 / 14.7	25/64 / 9.9
205200	25/32 / 19.8	13/64 / 5.2	7/16 / 11.1	.396 / 10.1	45°	5/8 / 15.9	13/32 / 10.3
205410	3/4 / 19.1	3/16 / 4.8	3/8 / 9.5	.256 / 6.5	90°	21/32 / 16.7	15/32 / 11.9
205400	3/4 / 19.1	13/64 / 5.2	7/16 / 11.1	.396 / 10.1	90°	47/64 / 18.7	1/2 / 12.7

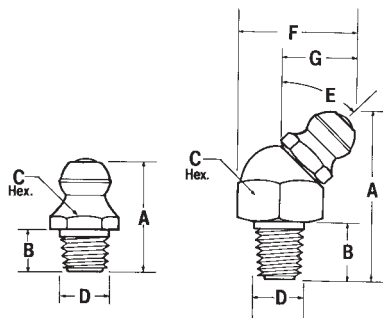

Drive Type Fittings

Drive type fittings are designed for fast production line installation in untapped holes to save thread tapping costs. Circumferential serrations on shank provide a hydraulic tight seal when fitting is installed properly. Cannot be used where high lubricant back pressures can be developed.

Hole sizes and shank dimensions are for reference use only. To determine optimum hole size, test applications should be conducted using the type of material into which the fitting is to be installed—steel, cast iron, brass, aluminum, etc. Production tolerances of hole size must be taken into consideration when test is conducted.

Drive Type Fittings

Model No.	A in. / mm	B in. / mm	C in. / mm	D in. / mm	E	F in. / mm	G in. / mm
5033	9/16 / 14.3	1/4 / 6.4	5/16 / 7.9	.196 / 5.0	—	—	—
5031	37/64 / 14.7	1/4 / 6.4	3/8 / 9.5	.322 / 8.2	—	—	—
5036	5/8 / 15.9	1/4 / 6.4	7/16 / 11.1	.383 / 9.7	—	—	—
5385	23/32 / 18.3	7/32 / 5.6	3/8 / 9.5	.196 / 5.0	65°	1 1/16 / 17.5	1/2 / 12.7
5318	49/64 / 19.4	9/32 / 7.1	3/8 / 9.5	.259 / 6.6	65°	1 1/16 / 17.5	1/2 / 12.7



No. 5033

For 3/16" / 4.8mm
Dia. Hole



No. 5031

For 5/16" / 7.9 mm
Dia. Hole



No. 5036

For 5/8" / 9.5mm
Dia. Hole



No. 5385

For 3/16" / 4.8mm
Dia. Hole



No. 5318

For 1/4" / 6.4mm Dia. Hole

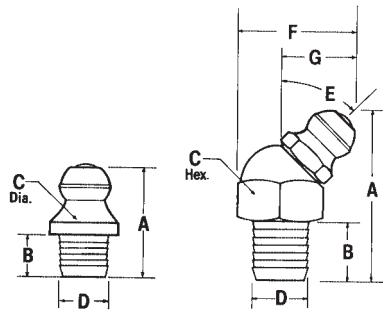

Stainless Steel Fittings

Select Lincoln stainless steel fittings for marine applications, food processing machinery, sewage disposal systems, or any use where protection against corrosive elements is a design criteria. Stainless steel ball checks and springs are securely housed in passivated austenitic type 303 stainless steel bodies for maximum usable life and performance. To avoid use of inferior substitutes specify Lincoln Stainless Steel fittings by part number on your drawings.



No. 5010-9

1/4" -28 Taper Th'd.
(SAE-LT)



No. 5000-9

1/8" P.T.F. Spec. Extra
Short



No. 5210-9

1/4" -28 Taper Th'd.
(SAE-LT)



No. 5410-9

1/4" -28 Taper Th'd.
(SAE-LT)



No. 5033-9

For 3/16" / 4.8mm
Dia. Hole

Stainless Steel Fittings

Model No.	A in. / mm	B in. / mm	C in. / mm	D in. / mm	E	F in. / mm	G in. / mm
5010-9	17/32 / 13.5	3/16 / 4.8	5/16 / 7.9 Hex.	.260 / 6.6	—	—	—
5000-9	41/64 / 16.3	9/32 / 7.1	7/16 / 11.1 Hex.	.400 / 10.2	—	—	—
5210-9	13/16 / 20.6	13/64 / 5.2	3/8 / 9.5 Hex.	.260 / 6.6	45°	37/64 / 14.7	25/64 / 9.9
5410-9	3/4 / 19.1	3/16 / 4.8	3/8 / 9.5 Hex.	.260 / 6.6	90°	21/32 / 16.7	15/32 / 11.9
5033-9	9/16 / 14.3	1/4 / 6.4	5/16 / 7.9 Dia.	.196 / 5.0	—	—	—

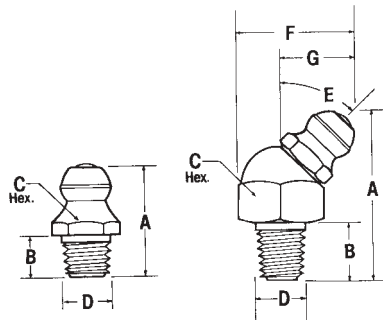



No. 5045
1/8" N.P.T.F.

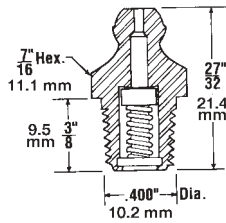

Leakproof Fittings

Leakproof fittings are a special purpose fitting for use in those applications where a positive seal is essential. A special synthetic rubber seal, conforming with ASTM D2000 and SAE J200 specifications, is used to provide an effective seal against light or heavy viscosity lubricants and will withstand a back pressure up to 5,000 psig (345 bars). Not suitable as a check valve against high, sustained back pressure. Check and spring are designed to permit easy flow of lubricants.



1/8" P.T.F.
Spec. Short

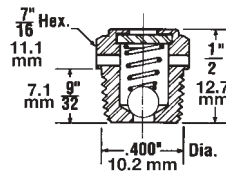

Pressure Relief Valves

Use wherever control of oil or grease pressure is required. Releases pressure build up during equipment operation or when filling gear cases, or bearing housings with pressure guns. Twin vent ports provide visual indication of pressure relief. Select valve with pressure range best suited to design application.

Model	Relief Pressure
5677	1 to 5 psig / .07 to .34 bars
5678	7 1/2 to 15 psig / .52 to 1 bars
5679	15 to 25 psig / 1 to 1.7 bars
5680	45 to 80 psig / 3.1 to 5.5 bars

Operating parts are positioned internally for maximum protection against entry of dirt or valve damage. Ball check is located at base of valve body as close as possible to protected material. Not recommended to be used below the fluid level.



No. 5099
1/8" P.T.F. Spec. Extra Short

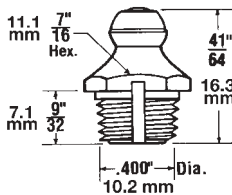

Safety Vent Fitting

Required for use in those applications where a build up of pressure in the bearing is undesirable or damaging. A vent slot cut vertical to the threads provides an air escape during bearing fill and when grease appears serves as a bearing fill indicator. Vent slot restriction permits bearing fill without build up of prohibitive pressure.



No. 5698
1/8" P.T.F. Spec. Short

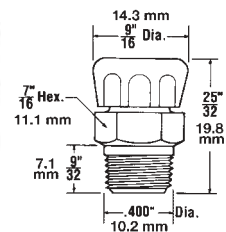

Atmospheric Vent

For use on differentials, transmissions, and gear boxes. It allows air to escape and enter as the internal pressure increases or decreases. The cap prevents dirt from entering. Must be installed above the normal level of fluid.



No. 5701
1/8" N.P.T.F.



No. 5706
1/4" N.P.T.F.

Button Head Fittings

Lincoln standard button head fittings are designed for use where volume flow of lubricant is required, such as bearings on earth moving equipment, conveyors, and mining machinery. Heat treated and zinc plated for long service life.



No. 5711
3/8" N.P.T.F.

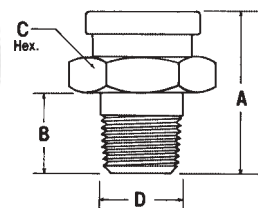

Model No.	A in. / mm	B in. / mm	C in. / mm	D in. / mm
5701	3/4 / 19.1	23/64 / 9.1	5/8 / 15.9	.405 / 10.3
5706	27/32 / 21.4	7/16 / 11.1	5/8 / 15.9	.540 / 13.7
5711	1 1/16 / 27.0	37/64 / 14.7	3/4 / 19.1	.675 / 17.1



Style 1 Style 2

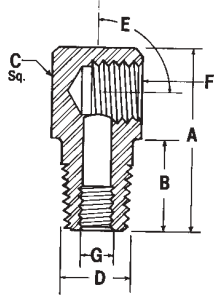

Street Elbows

Model No.	Style	A in. / mm	B in. / mm	C in. / mm	D in. / mm	E	F	G
20026	1	1 ³ / ₁₆ / 20.6	5 ¹ / ₁₆ / 7.9	1/2 / 12.7 Sq.	1/4-28 Taper	90°	1/8 PTF	—
247616	2	1 ¹ / ₁₆ / 27	1 ⁷ / ₃₂ / 13.5	1/2 / 12.7 Sq.	1/4-28 Taper	45°	1/8 PTF	—
20028	2	1 / 25.4	1 ⁵ / ₃₂ / 11.9	1/2 / 12.7 Sq.	1/8 PTF	45°	1/8 PTF	—
20031	1	1 ³ / ₁₆ / 20.6	9 ³ / ₃₂ / 7.1	1/2 / 12.7 Sq.	1/8 PTF	90°	1/8 PTF	—
20029	1	1 / 25.4	1 ⁵ / ₃₂ / 11.9	1/2 / 12.7 Sq.	1/8 PTF	90°	1/8 PTF	—
13155	1	1 / 25.4	3/8 / 9.5	1/2 / 12.7 Sq.	1/8 NPSM	90°	1/8 NPTF	1/4-28 UNF
13129	1	1 ¹ / ₂ / 38.1	7/8 / 22.2	5/8 / 5.9 Sq.	1/8 NPTF	90°	1/8 NPTF	—

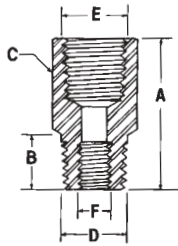

Adapters

Model	A in. / mm	B in. / mm	C in. / mm	D	E	F
20024	7/8 / 22.2	5/16 / 7.9	1/2 / 12.7 Hex.	1/4-28 Taper	1/8 NPSF	—
10182	1 ⁵ / ₁₆ / 23.8	3/8 / 9.5	9/16 / 14.3 Hex.	1/8 NPTF	1/8 NPTF	—
13154	7/8 / 22.2	3/8 / 9.5	1/2 / 12.7 Sq.	1/8 NPSM	1/8 NPTF	1/4-28 UNF
14054	7/8 / 22.2	7/16 / 11.1	1/2 / 12.7 Sq.	1/8 NPSM	1/8 NPTF	1/4-28 UNF



No. 12511
1/8" P.T.F. Spec. Extra Short

Plugs

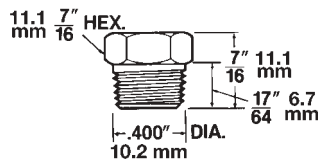



Fitting Installation and Removal Tools

Model 11485

For use to install straight drive type fittings into untapped holes.

Model 11509

For use to install angle drive type fittings into untapped holes.



Easy Out Tool

Combination tool for removing worn or broken fittings and retapping holes for new fitting installation, two models available:

Model G904

For tapping $\frac{1}{4}$ " -28 threads and removal of both $\frac{3}{8}$ " and $\frac{5}{16}$ " Hex, straight or angle fittings.

Model G905

For tapping $\frac{1}{8}$ " NPT threads and removal of both $\frac{7}{16}$ " Hex, straight or angle fittings.

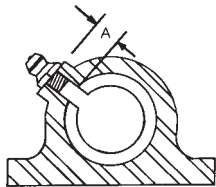

Depth of Engagement

When selecting a lubrication fitting, either straight, angle, standard thread, spin drive, or straight drive, be sure to measure engagement depth "A," taking manufacturing tolerance into consideration. Then select fitting with thread length or drive shank length that will not penetrate bearing material or rest against rotating member.

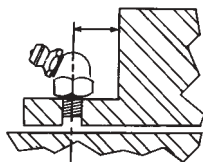

Turning Radius

The turning radius is given for all angle fittings shown in this manual. Be sure that this is taken into consideration during initial machine design and then select a fitting with a turning radius that will permit easy production line installation.

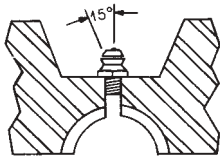

Deep Set Fittings

Deep set fittings are sometimes necessary in machine design. When required, make sure sufficient clearance is provided for easy disengagement of hydraulic coupler.

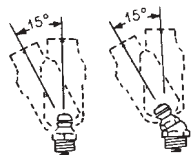

Angularity of Contact

Lincoln hydraulic couplers and fittings are designed to provide a hydraulic seal at any coupler angle up to 15° . Movement beyond this angle will cause coupler to disengage.

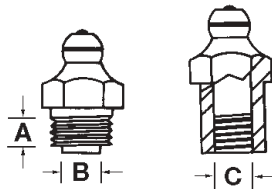

Determination of Pipe Thread Sizes

Nominal Pipe Thread Size	Threads Per Inch	Major Dia. B or C in./mm	Nominal Engagement For Tight Joint A in./mm
1/8"	27	.405 / 10.3	1/4 / 6.4
1/4"	18	.540 / 13.7	3/8 / 9.5
3/8"	18	.675 / 17.1	3/8 / 9.5
1/2"	14	.840 / 21.3	1/2 / 12.7
3/4"	14	1.050 / 26.7	9/16 / 14.3
1"	11 1/2	1.315 / 33.4	1 1/16 / 17.5

Drill Size Selection

Fitting Thread Size	Tap Drill Selection for Standard Thread Fitting	Drill Size Selection for Spin Drive Fittings
1/4" -28	#3 (for soft metal, use #5)	"A" - .234" / 5.9mm Dia. *
5/16" -32	9/32" / 7.1mm (for soft metal, use "J")	—
1/8" Pipe	1 1/32" / 8.7mm (for soft metal, use "R")	3/8 - .375" / 9.5mm Dia. *
1/4" Pipe	7/16" / 11.1mm	—

* Drill sizes given are nominal and may vary with different types of material. For maximum effectiveness, test applications should be conducted using the type of material into which the fitting is to be installed (steel, cast iron, brass, aluminum, etc.). Production tolerances of hole must be taken into consideration when conducting test.

Lubrication Fitting Thread Symbols

The identification symbols and their meaning which have been adopted for the various threads used in the manufacture of lubrication fittings are given below:

Symbol	Meaning
NPT	American Standard Taper Pipe Thread
NPTF	Dryseal American Standard Taper Pipe Thread
PTF	Same as NPTF except full thread length has been shortened by one thread on small end of thread—also designated as PTF—SAE Short
PTF Special Short	Same as PTF Short except one full thread has been shortened from large end of thread
PTF Special Extra Short	Same as PTF Short except two full threads have been shortened from large end of thread
NPSF	Dryseal American Fuel Internal Straight Pipe Thread
NPSI	Dryseal American Intermediate Internal Straight Pipe Thread
NPSM	American Standard Straight Mechanical Pipe Thread
1/4" -28 Taper Thread (SAE-LT)	Thread has a 3/4" taper per foot and a pitch diameter of .2257/.2224 at small end. The mating tapped hole is 1/4" -28 UNF 3B straight thread. Tap drill must not exceed .215" diameter.
1/4" -28 Special Taper Drive Thread	Thread Forming-Forms thread in mating part during installation—when removed can be replaced by standard 1/4" -28 taper thread (SAE-LT) fitting.
1/8" Pipe Special Taper Drive Thread	Thread Forming-Forms thread in mating part during installation—when removed can be replaced by standard 1/8" -27 PTF series fitting.

Symbol	Designation	Symbol	Designation
N	American Standard	S	Straight
P	Pipe	M	Mechanical
T	Taper	I	Intermediate
F	Fuel	LT	Lubrication Thread

Hard-to-reach lubrication fittings present a major maintenance problem for the proper care of all types of machinery. Hidden or guarded lubrication fittings can mean production downtime, higher operating and maintenance costs and risk of personal injury to operators and employees—all directly traceable to poor lubrication fitting access. How do you eliminate these problems? Lincoln's Remote Lube Fitting Systems benefit you by providing easy access to lubrication fittings; lubrication is easier, quicker and safer; assures all bearings will be lubricated—and can be safely lubricated while machine is operating; and finally, it's possible to reach hidden, inaccessible or hazardous bearings.



Junction Blocks

Junction block surface mount systems are used to bring multiple lubrication points to a common, easily accessible location. The junction blocks provide a means for coupling lubricant feed lines to bearings with lubrication fittings. They are available in three basic design groups and may be mounted in multiple units to meet all application requirements.

Group I

Have $1\frac{1}{32}$ " diameter mounting holes at 90° intervals, for use with $\frac{5}{16}$ " diameter mounting bolts. This permits horizontal or vertical positioning of lubricant inlet passages.

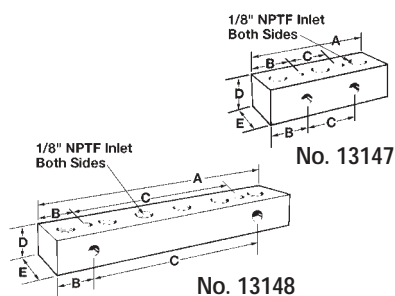

Part No.	No. of Inlets	A in. / mm	B in. / mm	C in. / mm	D in. / mm	E in. / mm
13147	3	2 $\frac{3}{4}$ / 69.9	$\frac{7}{8}$ / 22.2	1 / 25.4	$\frac{3}{4}$ / 19.1	$\frac{3}{4}$ / 19.1
13148	6	5 $\frac{3}{4}$ / 146.1	$\frac{7}{8}$ / 22.2	4 / 101.6	$\frac{3}{4}$ / 19.1	$\frac{3}{4}$ / 19.1

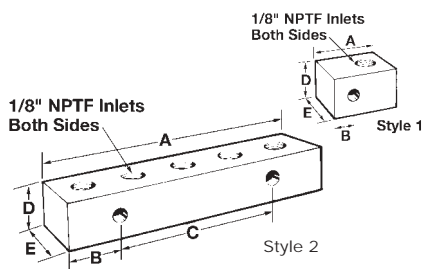

Group II

Have $\frac{9}{32}$ " diameter mounting holes for use with $\frac{1}{4}$ " diameter mounting bolts. Mounting holes are perpendicular to inlet passages permitting vertical positioning only.

Group II without Fitting Part No.	Style	Number of Inlets	A in. / mm	B in. / mm	C in. / mm	D in. / mm	E in. / mm
14570	1	1	1 $\frac{1}{4}$ / 31.8	$\frac{3}{8}$ / 9.5	—	$\frac{3}{4}$ / 19.1	$\frac{3}{4}$ / 19.1
14562	1	2	1 $\frac{3}{4}$ / 44.5	$\frac{7}{8}$ / 22.2	—	$\frac{3}{4}$ / 19.1	$\frac{3}{4}$ / 19.1
14771	2	3	2 $\frac{3}{4}$ / 69.9	$\frac{7}{8}$ / 22.2	1 / 25.4	$\frac{3}{4}$ / 19.1	$\frac{3}{4}$ / 19.1
14563	2	4	3 $\frac{3}{4}$ / 95.3	$\frac{7}{8}$ / 22.2	2 / 50.8	$\frac{3}{4}$ / 19.1	$\frac{3}{4}$ / 19.1
14564	2	5	4 $\frac{3}{4}$ / 120.7	$\frac{7}{8}$ / 22.2	3 / 76.2	$\frac{3}{4}$ / 19.1	$\frac{3}{4}$ / 19.1
14772	2	6	5 $\frac{3}{4}$ / 146.1	$\frac{7}{8}$ / 22.2	4 / 101.6	$\frac{3}{4}$ / 19.1	$\frac{3}{4}$ / 19.1

Mounting Bolts and Nuts



Part No.	A in. / mm	B in. / mm	C in. / mm
50057	1/4"-20	1 1/2 / 38.1	3/4 / 19.1

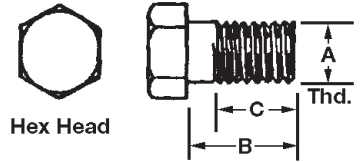

Part No.	A in. / mm	B in. / mm	C in. / mm
51304	1/4"-20	7/32 / 5.6	7/16 / 11.1
51026	5/16"-18	17/64 / 6.7	1/2 / 12.7

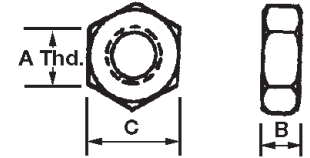

Accessories

Supply and Feed Line Hose



Part No.	Alvania #2 Grade Grease Filled Coils	Minimum Burst	Max. Working Pressure	Nominal Size		Minimum Bending	Hose Construction
				I.D.	O.D.		
241285	2 ft. / .6 M	10,000 psig 690 bar	4,000 psig 276 bar	1/8"	5/16"	3 1/2"	Nylon Tube, Dacron Braid, Polyurethane Cover
241286	26 ft. / 7.9 M						
241287	35 ft. / 10.7 M						
241288	40 ft. / 12.2 M						

Note: Use with hose ends No. 241289 or No. 246002 described below.

Feed Line Nylon Tubing



Part No.	Description	O.D.	Wall Thickness	Working Pressure	Minimum Bending Radius
242025	25 ft. / 7.6 M coil grease* filled	1/4" 6.4 mm	.050" 1.3 mm	625 psig 42.5 bar	.875" 22.2 mm
242050	50 ft. / 15.2 M coil grease* filled				
62357	100 ft./30.5 M coil non-grease filled				

*Alvania #2 grade grease.

Steel Tubing



Part No.	Description	Max. Working Pressure
62175	1/8" OD x .020" wall 25' coil 3.2mm OD x .5mm wall 7.6m coil	4400 psig 300 bar
62176	1/4" OD x .028" wall 25' coil 6.4 mm OD x .7mm wall 7.6m coil	2800 psig 190 bar

Installation Tools



Plastic Tube & Hose Cutter
Part No. 226-12508-5
 Replacement Blades
Part No. 226-13095-7



Hose Ends for 1/8" I.D. Hose

Part No.	Description
241289	1/8" NPT swedge on hose stud (Requires swedging tool)
246002	1/8" NPT field installable hose coupling (Swedging tool not required)

Installation Tools



Bulkhead Connectors



Part No.	Style	A	B	C	D
13154	1	1/8" PTF	1/2" / 12.7 mm	1/4" -28	3/16" / 4.8 mm
14054	1	1/8" PTF	1/2" / 12.7 mm	1/4" -28	1/4" / 6.4 mm
13155	2	1/8" PTF	1/2" / 12.7 mm	1/4" -28	3/16" / 4.8 mm
51055	Lock Nut 1/8" N.P.S.M. thread				

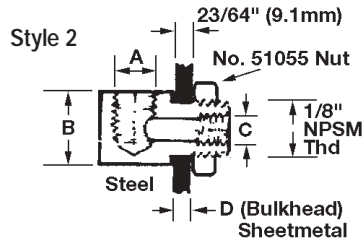
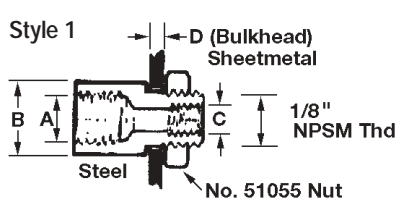

Adapter Union



Reducing Bushings

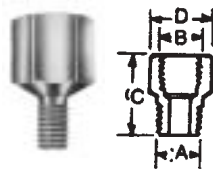

Part No.	A	B	C	D
20024	1/4" -28 THD	1/8" NPT	7/8" / 22.2mm	1/2" / 12.7mm Hex
67132	3/8" NPT	1/8" NPT	3/4" / 19.1mm	1 1/16" / 17.5mm Hex
20011	3/8" NPT	1/4" NPT	3/4" / 19.1mm	3/4" / 19.1mm Hex

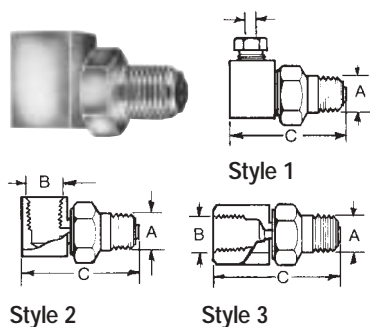

Swivels

Part No.	Style	A	B	C
66717	1	1/8" NPT	—	1 1/4" / 31.8mm
91048	2	1/8" NPT	1/8" NPT	1 1/4" / 31.8mm
91308	3	1/8" NPT	1/8" NPT	1 3/8" / 34.9mm

Note:
Not suitable for installations requiring continuous rotation.

Tube Connectors

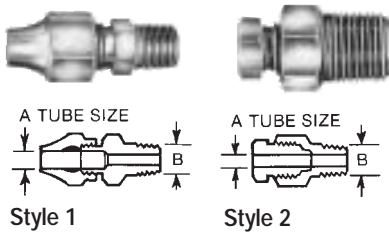

Part No.	Style	A	B	Type
66200	1	1/4"	1/8" NPT	STGT
66201	1	1/4"	1/8" NPT	90°
66414	2	1/8"	1/8" NPT	90°
66415	2	1/8"	1/8" NPT	STGT
66714	2	1/8"	1/4"-28 thd.	STGT
66716	2	1/8"	1/4"-28 thd.	90°



Compression Nut

No. 66260 for use with Style 2 Tube Connectors and 66717 Swivel.
For 1/8" O.D. Tubing. Thread size is 5/16"-24.

Sleeve

No. 68462 for use with Style 1 Tube Connectors. For 1/4" O.D. Tubing.

Nut

No. 68464 for use with Style 1 Tube Connectors. For 1/4" O.D. Tubing.

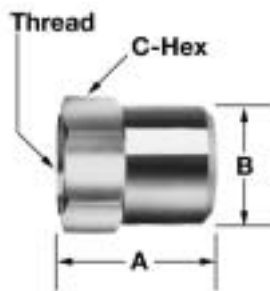

Zerk-Lock® Grease Fitting Adapter

Connects any 1/8" NPTF male tube adapter directly to a standard grease fitting. Aluminum, carbon steel construction; fluorocarbons elastomer seal. Useful for connecting to drive type fittings or metric fittings. Once installed, the Zerk-Lock cannot be removed from the fitting.

Model No.	Thread in. / mm	Dimensions		
		A in. / mm	B in. / mm	C-Hex in. / mm
270784	1/8" NPSL Female	.625 / 15.9	.500 / 12.7	.500 / 12.7

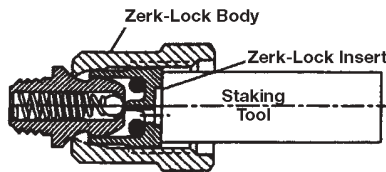

Installation Accessories



No. 250475 Staking Tool



No. 244047



No. 244048



No. 244054



No. 243699



No. 244058



No. 244055



No. 241290



No. 241293



No. 82618
No. 241388



No. 82617
No. 241389

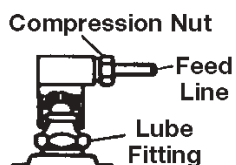

No. 66713



No. 13112

Quicklinc® Fittings

Use for connections to 1/4" nylon tubing only. Can be used with Zerk-Lock® adapter or be screwed directly into bearing.

Part No.	Description
244047	1/4" tube x 1/8" NPT male straight fitting
244048	1/4" tube x 1/8" NPT male 90° fitting
243699	1/4" tube x 1/8" NPT male 90° swivel fitting
244055	1/4" tube x 1/4" -28 male straight fitting
244054	1/4" tube x 1/4" -28 male 90° fitting
244058	1/4" tube x 1/4" tube splicer union

Standard Compression Fittings

Part No.	Description
241290	1/4" tube x 1/8" NPT male straight fitting
241293	1/4" tube x 1/8" NPT male 90° fitting

Snap-On Connector Fittings

Part No.	Description
241388	90° snap-on connector for 1/4" O.D. tubing
241389	Straight snap-on connector for 1/4" O.D. tubing
66713	Compression nut for 241388 and 241389
82617	Straight snap-on connector for 1/8" O.D. tubing
82618	90° snap-on connector for 1/8" O.D. tubing
13112	Compression nut for 82617 and 82618

Tube Clamps for 1/4" O.D. Tubing



Part No.	A	B	C	No. of Tubes
64533-1	—	1/4" / 6.4	3/8" / 9.5	1
64533-2	15/16" / 23.8 mm	1/2" / 12.7	3/8" / 9.5	2
64533-3	13/16" / 30.2 mm	3/4" / 19.1	3/8" / 9.5	3
64533-4	17/16" / 36.5 mm	1" / 25.4	3/8" / 9.5	4
64533-5	111/16" / 42.9 mm	1 1/4" / 31.8	3/8" / 9.5	5

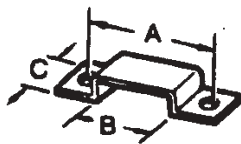

Tube Clamps for 1/8" O.D. Tubing

Part No.	A	B	C	No. of Tubes
64532-1	—	1/8" / 3.2	3/8" / 9.5	1
64532-2	1 1/16" / 17.5 mm	1/4" / 6.4	3/8" / 9.5	2
64532-3	1 3/16" / 20.6 mm	3/8" / 9.5	3/8" / 9.5	3
64532-4	1 5/16" / 23.8 mm	1/2" / 12.7	3/8" / 9.5	4
64532-5	1 1/16" / 27.0 mm	5/8" / 15.9	3/8" / 9.5	5

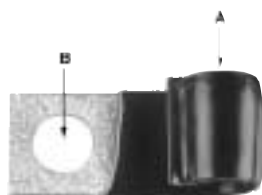

Insulated "J" Type Clamps

Part No.	A	B
68510	9/32" / 7.1 mm opening	13/32" / 10.3 dia. hole
68511	7/16" / 11.1 mm opening	13/32" / 10.3 dia. hole
68535	7/16" / 11.1 mm opening	17/32" / 13.5 dia. hole
68987	1 1/16" / 17.5 mm opening	7/16" / 11.1 dia. hole

Clip Screw



#6 Thd - 1/4" Long

No. 66202 for use in mounting 64532 and 64533 series tube clamps.



Spiral Wrap



Nylon Ties

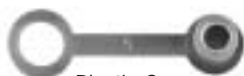

Plastic Cap

Bulk Supply and Feed Line Hose and Tubing

Part No.	Description
241110	Feed line bundling spiral wrap (10 ft. / 3 m length)
241054	Nylon ties (100 count poly bag) 7" / 177.8 m length
241055	Nylon ties (50 count poly bag) 7" / 177.8 m length
241056	Nylon ties (25 count poly bag) 7" / 177.8 m length
242125	Plastic grease fitting cap



Our popular fitting models are packaged in a convenient 100 piece carton for your small order requirements. Order a quantity of one and receive 100 pieces of that fitting.

1/8" NPT

100 Pc. Box No.	Bulk No.	Description	Length
5000C	5000	Straight	21/32"
5003C	5003	Straight	11/4"
5200C	5200	45° angle	7/8"
5300C	5300	65° angle	29/32"
5400C	5400	90° angle	27/32"



1/4" NPT

100 Pc. Box No.	Bulk No.	Description	Length
5050C	5050	Straight 1/4" NPT	15/16"
5350C	5350	65° angle 1/4" NPT	15/32"

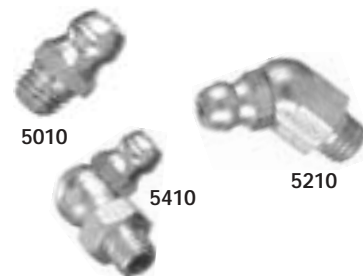

1/4"-28 SAE

100 Pc. Box No.	Bulk No.	Description	Length
5010C	5010	Straight-short thread	1/2"
5013C	5013	Straight-long thread	11/16"
5527C	5527	Straight-short thread	31/64"
5210C	5210	45° angle-short thread	7/8"
5410C	5410	90° angle-short thread	25/32"

Metric

100 Pc. Box No.	Bulk No.	Description	Length
5175C	5175	Straight	6mm
5176C	5176	45°	6mm
5177C	5177	90°	6mm
5178C	5178	Straight	8mm
5179C	5179	45°	8mm
5180C	5180	90°	8mm
5181C	5181	Straight	10mm
5182C	5182	45°	10mm
5183C	5183	90°	10mm



Button Head

100 Pc. Box No.	Bulk No.	Description	Length
5701C	5701	1/8" NPT(m) thread	25/32"
5706C	5706	1/4" NPT(m) thread	53/64"

Drive Type

100 Pc. Box No.	Bulk No.	Description	Length	Drive Dia.
5033C	5033	Straight	9/16"	3/16"
5385C	5385	65° angle	13/16"	3/16"
5031C	5031	Straight	37/64"	5/16"

Lubrication Fittings & Accessories

Carton Quantities



Our standard bulk fittings are boxed in easy to handle cartons weighing approximately 30 pounds. The cartons are approximately 9"x9"x5". Order your fittings in these standard carton quantity increments to reduce your handling time.

Model No.	Standard Box Quantity	Model No.	Standard Box Quantity
5000	2500	5410-9	1500
5000-1	2500	5505	1000
5000-9	2500	5527	6000
5003	1200	5677	2700
5009	500	5678	2700
5010	5000	5679	2700
5010-9	5000	5680	2700
5013	4500	5698	1300
5014	3000	5701	1000
5031	3500	5706	800
5033	5500	5711	400
5033-9	5500	13154	1000
5036	2700	13155	750
5045	1500	20024	1300
5050	1000	20026	1300
5099	2500	20028	1000
5200	1500	20029	900
5210	2000	20031	1000
5210-9	2000	205000	2500
5300	1300	205010	5000
5308	1000	205200	1500
5318	2000	205210	2000
5350	700	205400	1300
5385	2200	205410	1500
5400	1300	240646	5000
5410	1500		

Steel Tubing

For supply and feedlines.

Model No.	Size (O.D. x Wall)			Working Pressure	Type
	O.D. in.	Wall in.	Length ft. / m		
62175	1/8	.020	25 / 7.6	4400 psig / 300 bar	coil
62176	1/4	.028	25 / 7.6	2800 psig / 190 bar	coil
62249	3/8	.028	25 / 7.6	1850 psig / 126 bar	coil
62711	5/8	.083	20 / 6.1 (140' length 7x20')	3300 / 224	str

Type 304 Stainless Steel Tubing

For supply and feedlines. For corrosive environments. ASTM A-269 specs.

Model No.	Size (O.D. x Wall)			Working Pressure	Type
	O.D. in.	Wall in.	Length ft. / m		
62948-9	1/8	.028	20/ 6.1	9000 psig / 612 bar	coil
62949-9	1/4	.028	20/ 6.1	4480 psig / 305 bar	coil
62950-9	3/8	.028	20/ 6.1	2980 psig / 203 bar	coil

Nylon Tubing

For feedlines. Temperature range 60°F to 200°F.

Model No.	Size (O.D. x Wall)			Working Pressure	Min. Bend Radius in.
	O.D. in.	Wall in.	Length ft. / m		
62256	1/8	.026	25 / 7.6	625 psig 42.5 bar	.375
62278			100 / 30.5		
62956			500 / 152		
62357	1/4	.050	100 / 30.5		.875

Single and Multiple Tube Clamps

For feedlines.

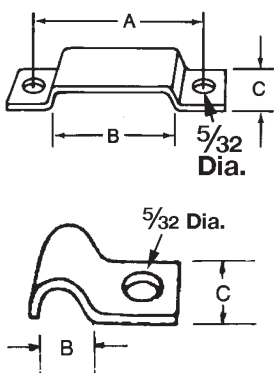

Clamp No.	Const.	No. Tubes	Tube Size in.	A in.	B in.	C in.	Screw No.	Screw Description	
64532-1	Steel	1	1/8 OD	—	1/8	3/8	66202	No. 6 roundhead 1/4" LG, Use No. 30 drill	
64532-2		2		1 1/16	1/4	3/8			
64532-3		3		1 3/16	3/8	3/8			
64532-4		4		1 5/16	1/2	3/8			
64532-5		5		1 11/16	5/8	3/8			
64533-1		1	1/4 OD	—	1/4	3/8			
64533-2				2	1 5/16	1/2			3/8
64533-3				3	1 3/16	3/4			3/8
64533-4				4	1 7/16	1			3/8
64533-5				5	1 11/16	1 1/4			3/8
69159-9	Type	1	1/8 OD	—	1/8	3/8	66202-9	No. 6 roundhead 1/4" LG, Use No. 30 drill	
69169-9	303	2		1 1/16	1/4	3/8			
69161-9	Stainless	3		1 3/16	3/8	3/8			
69163-9	Steel	5		1 1/16	5/8	3/8			

Single Tube Clamps

For supply lines.

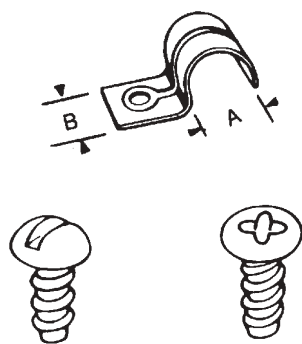

Clamp No.	Const.	Tube Size in.	A in.	B in.	Screw No.	Screw Description
360108	Steel	3/8 OD	3/8	1/2	66872	No. 10 round head, self-tapping 1/4" LG, use No. 17 drill
69164-9	Type 303	1/4 OD	1/4	3/8	66202-9	No. 6 round head, self-tapping 1/4" LG, use No. 30 drill
69165-9	Stainless Steel	3/8 OD	3/8	1/2	66872-9	No. 10 round head, self-tapping 1/4" LG, use No. 17 drill

Note: Screws listed in above tables. Order separately.

P Clamps

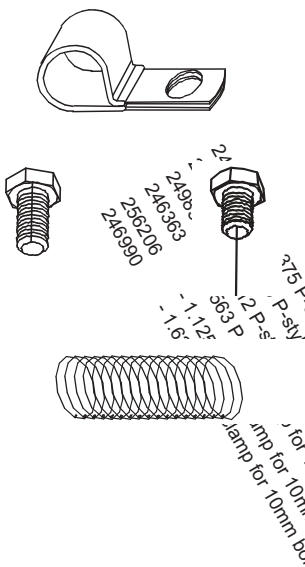

Clamp No.	Description	Material	Width in.	Length in.	Screw Description
249853	1 1/16" P style clamp	CRS	1	2 7/32	Use 249848 or 249849 bolts
249913	3/8" P style clamp	CRS	1		
270931	3/4" P style clamp	CRS	1	2 9/16	

Spring Coil

Clamp No.	Description	Material	Width in.	Screw Description
246372	20' spring coil	Steel	3/8" ID	Use 249848 or 249849 bolts

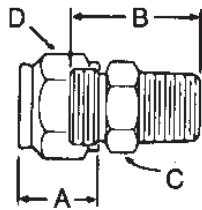

Heavy Duty Tube Fittings—Male Connector

Tube to male pipe thread. For supply lines. Carbon steel unless noted (*) otherwise.

Part No.	Tube O.D. in.	Pipe Thread in.	A in.	B in.	Hex. C in.	Hex. D in.	Working Press. psig / bar
69068	1/4	1/8 NPT	19/32	61/64	1/2	5/8	5000 / 340
*69068-9	1/4	1/8 NPT	19/32	61/64	1/2	5/8	5000 / 340
69069	1/4	1/4 NPT	19/32	15/32	5/8	5/8	5000 / 340
*69069-9	1/4	1/4 NPT	19/32	15/32	5/8	5/8	5000 / 340
69070	3/8	1/8 NPT	3/4	1	5/8	3/4	5000 / 340
*69070-9	3/8	1/8 NPT	3/4	1	5/8	3/4	5000 / 340
69071	3/8	1/4 NPT	3/4	1 13/64	5/8	3/4	5000 / 340
*69071-9	3/8	1/4 NPT	3/4	1 13/64	5/8	3/4	5000 / 340
69072	3/8	3/8 NPT	3/4	1 13/64	3/4	3/4	5000 / 340

* 316 Stainless Steel

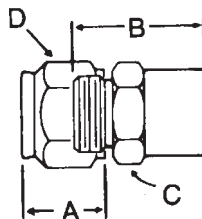

Heavy Duty Tube Fittings—Female Connector

Tube to female pipe thread. For supply lines. Carbon steel unless noted (*) otherwise.

Part No.	Tube O.D. in.	Pipe Thread in.	A in.	B in.	Hex. C in.	Hex. D in.	Working Press. psig / bar
69073	1/4	1/8 NPT	19/32	61/64	9/16	5/8	5000 / 340

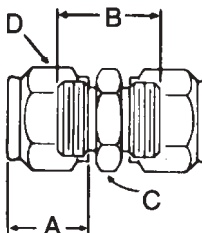

Heavy Duty Tube Fittings—Union Connector

Tube to tube. For supply lines. Carbon steel unless noted (*) otherwise.

Part No.	Tube O.D. in.	A in.	B in.	Hex. C in.	Hex. D in.	Working Press. psig / bar
69077	1/4	19/32	61/64	1/2	5/8	6000 / 400
69078	3/8	3/4	1 1/16	5/8	3/4	6000 / 400
15	5/8	3 1/32	3 1/32	1 1/2	1 1/8	5000 / 340

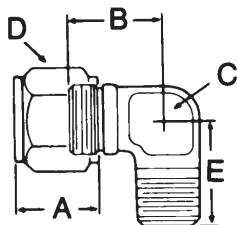

Heavy Duty Tube Fittings—Male Elbow

Tube to male pipe thread. For supply lines. Carbon steel unless noted (*) otherwise.

Part No.	Tube O.D. in.	Pipe Thd. in.	A in.	B in.	Flats C in.	Hex. D in.	E in.	Working Press. psig / bar
69079	1/4	1/8 NPT	19/32	3/4	7/16	5/8	25/32	5000 / 340
*69079-9	1/4	1/8 NPT	19/32	3/4	7/16	5/8	25/32	5000 / 340
69080	1/4	1/4 NPT	19/32	7/8	9/16	5/8	1 1/16	5000 / 340
*69081	3/8	1/8 NPT	3/4	59/64	9/16	3/4	7/8	5000 / 340
69082	3/8	1/4 NPT	3/4	59/64	9/16	3/4	1 3/32	5000 / 340
*69082-9	3/8	1/4 NPT	3/4	59/64	9/16	3/4	1 3/32	5000 / 340
69083	3/8	3/8 NPT	3/4	17/64	3/4	3/4	17/32	5000 / 340
12D	5/8	1/2 NPT	3 1/32	1 1/8	1	1 1/8	1 1/4	4500 / 300

* 316 Stainless Steel

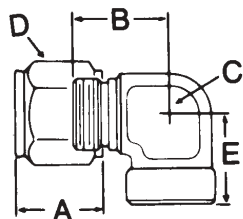

Heavy Duty Tube Fittings—Female Elbow

Tube to female pipe thread. For supply lines. Carbon steel unless noted (*) otherwise.

Part No.	Tube O.D. in.	Pipe Thd. in.	A in.	B in.	Flats C in.	Hex. D in.	E in.	Working Press. psig / bar
69084	1/4	1/8 NPT	19/32	25/32	1/2	5/8	1 1/16	5000 / 340
*69085	1/4	1/4 NPT	19/32	1	3/4	5/8	7/8	5000 / 340

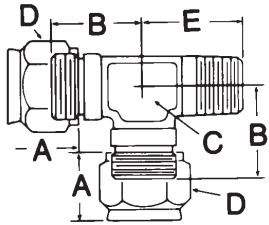

Heavy Duty Tube Fittings—Male Run Tee

Tube to male pipe thread to tube. For supply lines. Carbon steel unless noted (*) otherwise.

Part No.	Tube O.D. in.	Pipe Thd. in.	A in.	B in.	Flats C in.	Hex. D in.	E in.	Working Press. psig / bar
69089	1/4	1/4 NPT	19/32	25/32	1/2	5/8	15/16	5000 / 340

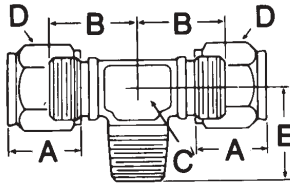

Heavy Duty Tube Fittings—Male Branch Tee

Tube to tube to male pipe thread. For supply lines. Carbon steel unless noted (*) otherwise.

Part No.	Tube O.D. in.	Pipe Thd. in.	A in.	B in.	Flats C in.	Hex. D in.	E in.	Working Press. psig / bar
69093	3/8	1/4 NPT	3/4	63/64	5/8	3/4	11/16	5000 / 340

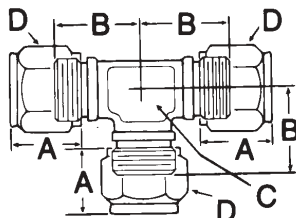

Heavy Duty Tube Fittings—Union Tee

Tube to tube to tube. For supply lines. Carbon steel unless noted (*) otherwise.

Part No.	Tube O.D. in.	A in.	B in.	Flats C in.	Hex. D in.	Working Press. psig / bar
69094	1/4	19/32	3/4	7/16	5/8	5000 / 340
*69094-9	1/4	19/32	3/4	7/16	5/8	5000 / 340
69095	3/8	3/4	63/64	5/8	3/4	5000 / 340
*69095-9	3/8	3/4	63/64	5/8	3/4	5000 / 340

* 316 Stainless Steel

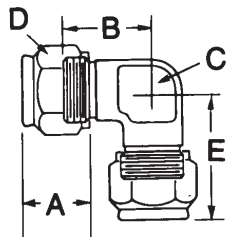

Heavy Duty Tube Fittings—Union Elbow

Tube to tube. For supply lines. Carbon steel unless noted (*) otherwise.

Part No.	Tube O.D. in.	A in.	B in.	Flats C in.	Hex. D in.	Working Press. psig / bar
17	5/8	31/32	1 1/8	1	1 1/8	4500 / 300

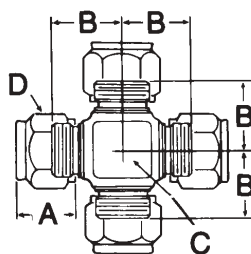

Heavy Duty Tube Fittings—Cross

Tube to tube to tube to tube. For supply lines. Carbon steel unless noted (*) otherwise.

Part No.	Tube O.D. in.	A in.	B in.	Flats C in.	Hex. D in.	Working Press. psig / bar
69096	1/4	19/32	3/4	9/16	5/8	5000 / 340
69097	3/8	3/4	61/64	3/4	3/4	5000 / 340

Heavy Duty Tube Fittings—Sleeve

For supply lines. Carbon steel unless noted (*) otherwise.



Model No.	Tube O.D. - in.
69098	1/4
69099	3/8
*69099-9	3/8

* 316 Stainless Steel

Heavy Duty Tube Fittings—Nut

For supply lines. Carbon steel unless noted (*) otherwise.

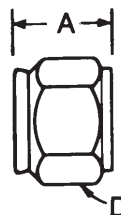

Model No.	Tube O.D. in.	A in.	D in.
69100	1/4	19/32	5/8
69101	3/8	3/4	3/4
*69101-9	3/8	3/4	3/4

* 316 Stainless Steel

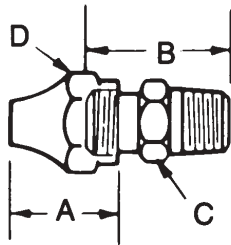

Standard Duty Tube Fittings—Male Connector

Tube to male pipe thread. For supply and feed lines. Brass unless noted (*) otherwise.

Model No.	Tube O.D. in.	Pipe Thd. in.	A in.	B in.	Hex. C in.	Hex. D in.	Working Press. psig / bar
66200	1/4	1/8 NPT	3/4	7/8	7/16	9/16	400 / 30
66211	1/4	1/4 NPT	3/4	1 1/16	9/16	9/16	400 / 30
68415	3/8	1/8 NPT	7/8	31/32	9/16	1 1/16	400 / 30
66846	3/8	1/4 NPT	7/8	1 5/32	9/16	1 1/16	400 / 30
*69169-9	1/8	1/8 NPT	33/64	27/32	7/16	1/2	400 / 30

* 316 Stainless Steel

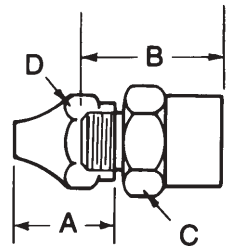

Standard Duty Tube Fittings—Female Connector

Tube to female pipe thread. For supply and feed lines. Brass unless noted (*) otherwise.

Model No.	Tube O.D. in.	Pipe Thd. in.	A in.	B in.	Hex. C in.	Hex. D in.	Working Press. psig / bar
68943	1/4	1/8 NPT	3/4	29/32	9/16	9/16	400 / 30
67372	1/4	1/4 NPT	3/4	1 1/32	1 1/16	9/16	400 / 30

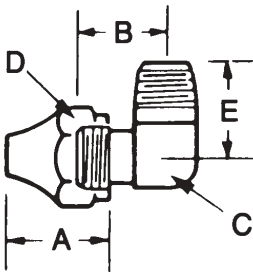

Standard Duty Tube Fittings—Male Elbow

Tube to male pipe thread. For supply and feed lines. Brass unless noted (*) otherwise.

Model No.	Tube O.D. in.	Pipe Thd. in.	A in.	B in.	Flats C in.	Hex. D in.	E in.	Working Press. psig / bar
66201	1/4	1/8 NPT	3/4	19/32	7/16	9/16	23/32	400 / 30
66210	1/4	1/4 NPT	3/4	5/8	9/16	9/16	3/4	400 / 30
68412	3/8	1/8 NPT	7/8	1 1/16	9/16	1 1/16	1 1/16	400 / 30
66762	3/8	1/4 NPT	7/8	23/32	9/16	1 1/16	29/32	400 / 30
68414	3/8	3/8 NPT	7/8	27/32	1 1/16	1 1/16	31/32	400 / 30
*69166-9	1/8	1/8 NPT	33/64	21/32	7/16	1/2	3/4	400 / 30

* 316 Stainless Steel

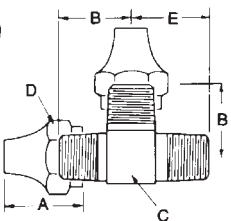

Standard Duty Tube Fittings—Male Run Tee

For supply and feed lines. Brass unless noted (*) otherwise. Tube to male pipe thread to tube.

Model No.	Tube O.D. in.	Pipe Thd. in.	A in.	B in.	Flats C in.	Hex. D in.	E in.	Working Press. psig / bar
68615	1/4	1/8 NPTF	3/4	21/32	7/16	9/16	23/32	400 / 30

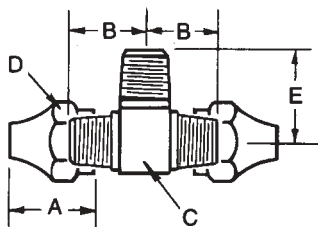

Standard Duty Tube Fittings—Male Branch Tee

Tube to tube to male pipe thread. For supply and feed lines. Brass unless noted (*) otherwise.

Model No.	Tube O.D. in.	Pipe Thd. in.	A in.	B in.	Flats C in.	Hex. D in.	E in.	Working Press. psig / bar
66651	1/4	1/8 NPTF	3/4	21/32	7/16	9/16	23/32	400 / 30
66876	3/8	1/4 NPTF	7/8	29/32	9/16	1 1/16	29/32	400 / 30

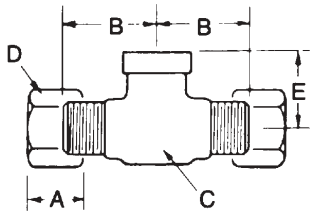

Standard Duty Tube Fittings—Female Branch Tee

Tube to tube to female pipe thread. For supply and feed lines. Brass unless noted (*) otherwise.

Model No.	Tube O.D. in.	Pipe Thd. in.	A in.	B in.	Flats C in.	Hex. D in.	E in.	Working Press. psig / bar
67374	3/8	1/4 NPTF	3/4	1 1/16	3/4	1 1/16	7/8	400 / 30

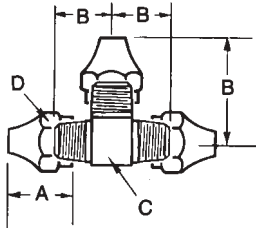

Standard Duty Tube Fittings—Union Tee

Tube to tube to tube. For supply and feed lines. Brass unless noted (*) otherwise.

Model No.	Tube O.D. in.	A in.	B in.	C in.	Hex. D in.	Working Press. psig / bar
66650	1/4	3/4	5/8	7/16	9/16	400 / 30
66878	3/8	7/8	23/32	9/16	1 1/16	400 / 30

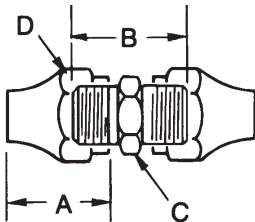

Standard Duty Tube Fittings—Union

Tube to tube. For supply and feed lines. Brass unless noted (*) otherwise.

Model No.	Tube O.D. in.	A in.	B in.	Hex C in.	Hex. D in.	Working Press. psig / bar
68468	1/4	3/4	25/32	7/16	9/16	400 / 30



Standard Duty Tube Fittings—Sleeve

For supply and feed lines. Carbon steel unless noted (*) otherwise. Included with all standard duty fittings.

Model No.	Tube O.D. - in.
68462	1/4
68463	3/8
*69170-9	1/8

* 316 Stainless Steel

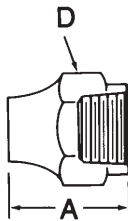

Standard Duty Tube Fittings—Nut

For supply and feed lines. Carbon steel unless noted (*) otherwise. Included with all standard duty fittings.

Model No.	Tube O.D. in.	A in.	Hex D in.
68464	1/4	3/4	9/16
68465	3/8	7/8	1 1/16
*69171-9	1/8	33/64	1/2

* 316 Stainless Steel

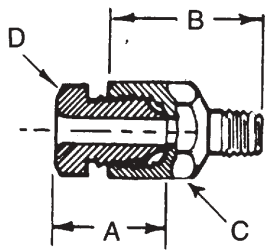

Threaded Sleeve Tube Fittings—Straight

Tube to male thread. For feed lines. Carbon steel with brass nut unless noted (*) otherwise.

Model No.	Tube O.D. in.	Thread in.	A in.	B in.	Hex. C in.	Hex. D in.	Working Press. psig / bar
66771	1/8	10-32	1/2	1 1/16	3/8	5/16	400 / 30
66714	1/8	1/4 -28	1/2	5/8	3/8	5/16	400 / 30
*66714-9	1/8	1/4 -28	1/2	5/8	3/8	5/16	400 / 30
66772	1/8	1/4 -28	1/2	1 1/16	3/8	5/16	400 / 30
66730	1/8	5/16 -32	1/2	1 1/16	3/8	5/16	400 / 30
66773	1/8	3/8 -24	1/2	1 1/16	7/16	5/16	400 / 30
**66415	1/8	1/8 NPTF	1/2	5/8	7/16	5/16	400 / 30

* 303 Stainless Steel ** Brass

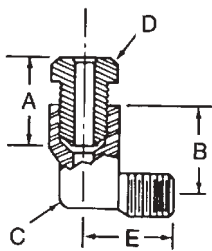

Threaded Sleeve Tube Fittings—90° Elbow

Tube to male thread. For feed lines. Brass with brass nut unless noted (*) otherwise.

Model No.	Tube O.D. in.	Thread in.	A in.	B in.	Flats C in.	Hex. D in.	E in.	Working Press. psig / bar
66716	1/8	1/4 -28	1/2	1/2	13/32	5/16	33/64	400 / 30
66414	1/8	1/4 NPTF	1/2	1/2	7/16	5/16	21/32	400 / 30

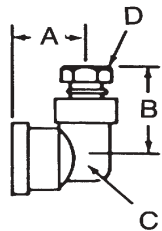

Threaded Sleeve Tube Fittings—90° Elbow

Tube to female pipe thread. For feed lines. Brass with brass nut unless noted (*) otherwise.

Model No.	Tube O.D. in.	Pipe Thread in.	A in.	B in.	Flats C in.	Hex. D in.	Working Press. psig / bar
66935	1/8	1/8 NPT	23/32	1 1/32	3/8	5/16	400 / 30

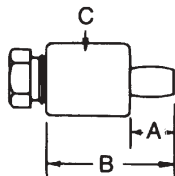

Threaded Sleeve Tube Fittings—Drive Type

For feed lines. Steel body with brass nut.

Model No.	Hole Size in.	Tube O.D. in.	A in.	B in.	Dia. C in.	Hex. D in.	Working Press. psig / bar
82092	3/16	1/8	13/64	45/64	7/16	5/16	400 / 30

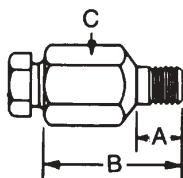

Threaded Sleeve Tube Fittings—Spin Drive Type

For feed lines. Steel body with brass nut.

Model No.	Hole Size in.	Tube O.D. in.	A in.	B in.	Hex C in.	Hex. D in.	Working Press. psig / bar
82093	1/4	1/8	5/32	5/8	7/16	5/16	400 / 30

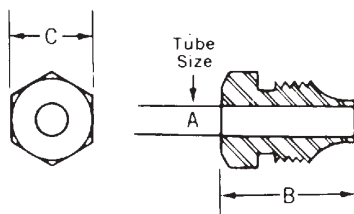

Threaded Sleeve Tube Fittings—Compression Nuts

For feed lines. Brass unless noted (*) otherwise.

Model No.	A Tube Size O.D. in.	B in.	C in.	Working Press. psig / bar
66260	1/8	1/2	5/16	400 / 30
*66260-9	1/8	1/2	5/16	400 / 30
66713	1/4	5/8	7/16	400 / 30

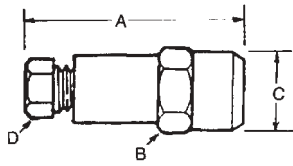

Snap-on Coupler Tube Fittings—Straight

Connect tubing to existing hydraulic (grease) fittings. Aluminum body, brass nut, Buna N packing.

Model No.	Tube O.D. Size - in.	A in.	B Hex in.	C in.	D Hex in.	Working Pressure
*82617	1/8	1.18	7/16	.43	1/4	400 psi
**241389	1/4	1.69	5/8	.43	7/16	30 bar

* Uses Model 13112 compression nut (included). **Uses 66713 compression nut (included).

Note: Coupling to grease fitting is a permanent connection.

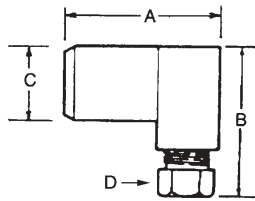

Snap-on Coupler Tube Fittings—90° Elbow

Connect tubing to existing hydraulic (grease) fittings. Aluminum body, brass nut, Buna N packing.

Model No.	Tube O.D. Size - in.	A in.	B Hex in.	C in.	D Hex in.	Working Pressure
*82618	1/8	.83	.86	.43	1/4	400 psi
**241388	1/4	1.03	1.18	.43	7/16	30 bar

* Uses Model 13112 compression nut (included). **Uses 66713 compression nut (included).

Note: Coupling to grease fitting is a permanent connection.

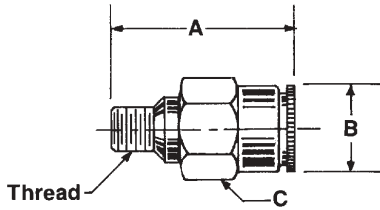

Quicklinc™ Tubing Adapter—Male Straight

Use with 1/4" O.D. non-metallic tube for quick installation. Tubing simply pushes into place without ferrules or flairs. Nickel plated brass construction.

Model No.	Tube O.D. Size - in.	Thread	Dimensions - Inches / mm			Max. Operating Pressure
			A	B	C-Hex	
244047	1/4	1/8" NPTF	.984 / 25	.460 / 11.7	.472 / 12	2400 psig / 165 bar
244055		1/4-28	.784 / 19.9			
244057		M6X1-6G Tapered	.965 / 24.5			

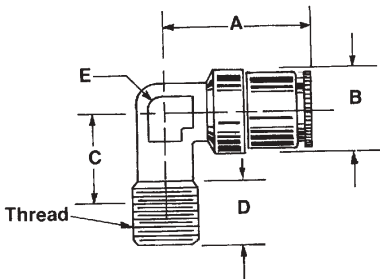

Quicklinc™ Tubing Adapter—Male 90° Elbow, Non-Swivel

Use with 1/4" O.D. non-metallic tube for quick installation. Tubing simply pushes into place without ferrules or flairs. Nickel plated brass construction.

Model No.	Tube O.D. Size - in.	Thread	Dimensions - Inches / mm					Max. Oper. Pressure
			A	B	C	D	E-Flat	
244048	1/4	1/8" NPTF	.905 23	.500 12.7	.531 / 13.5	.374 / 9.5	.394 10	2400 psig 165 bar
244054		1/4-28				.172 / 4.4		
244056		M6X1-6G Tapered				.590 / 15		

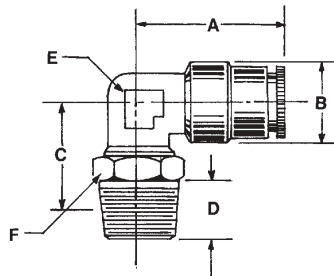

Quicklinc™ Tubing Adapter—Male 90° Elbow, Swivel

Use with 1/4" O.D. non-metallic tube for quick installation. Tubing simply pushes into place without ferrules or flairs. Nickel plated brass construction.

Model No.	Tube O.D. Size - in.	Thread	Dimensions - Inches / mm						Max. Oper. Pressure
			A	B	C	D	E-Flat	F-Hex	
243699	1/4	1/8" NPTF	.905 23	.500 12.7	.728 18.5	.374 9.5	.354 9	.472 12	2400 psig 165 bar

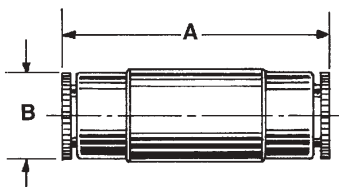

Quicklinc™ Tubing Adapter—Tube Union

Use with 1/4" O.D. non-metallic tube for quick installation. Tubing simply pushes into place without ferrules or flairs. Nickel plated brass construction.

Model No.	Tube O.D. Size - in.	Dimensions - Inches / mm		Max. Oper. Pressure
		A	B	
244058	1/4	1.397 / 35.5	.460 / 11.7	2400 psig / 165 bar

Supply Line and Material Hose

Type	I.D. in.	Wire Braid	Working Pressure	Min. Burst Pressure	Fittings in.	Min. Bend radius in.	Model No.	Length	
								in.	cm
75 High Pressure	¼	Double	5000 psig 340 bar	20000 psig 1360 bar	½ -27 female	4	75024	24	61
							75036	36	91.4
							75060	60	152.4
							75084	84	213
							75120	120	305
							75168	168	427
							75240	240	610
							75360	360	915
							75480	480	1220
75600	600	1525							
759 High Pressure	⅜	Double	4500 psig 306 bar	20000 psig 1360 bar	⅛ NPT male	2½	75936	36	91.4
							75948	48	122
							75960	60	152
76B High Pressure	⅜	Double	4000 psig 272 bar	16000 psig 1088 bar	½ NPT female	5	76024B	24	61
							76600B	600	1525
							76900B	900	2288
76A High Pressure	½	Double	3500 psig 238 bar	14000 psig 952 bar	½ NPT female	7	76024A	24	61
							76600A	600	1525
79 Volume Med. Pressure	⅜	Single	2250 psig 153 bar	9000 psig 612 bar	⅜ NPT male	5	79060	60	152.4
							79120	120	305
73 Med. Pressure	½	Single	1000 psig 68 bar	4000 psig 272 bar	½ NPT male		73024	24	61
							73036	36	91.4
							73060	60	152.4
							73120	120	305
							73240	240	610
							73360	360	915
							73480	480	1220
							73600	600	1525
							73900	900	2288
78 Volume Med. Pressure	⅝	Single	1500 psig 102 bar	6000 psig 408 bar	½ NPT male		78024	24	61
							78600	600	1525
1230 Med. Pressure	¾	Double	2250 psig 153 bar	9000 psig 612 bar	¾ NPT male		1230084	84	213
							1230120	120	305
							1230300	300	762.5
							1230600	600	1525
1625 Volume Med. Pressure	1	Double	2000 psig 136 bar	8000 psig 544 bar	1 NPT male	12	1625084	84	213
							1625120	120	305

Note: Refer to Design Guides for the correct hose for your system.

Feed Line Hose (SAE 30R-3 Type)

For flexible connections between lube outlets, anchor blocks, swivels, tube connectors and bearings. Hose is $\frac{3}{16}$ " I.D. x $\frac{3}{8}$ " O.D.

Series 71900

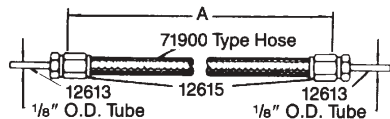

Model No.	Connections in.	Working Pressure	Min. Bend Radius in.	Length "A"	
				in.	cm
71908	$\frac{1}{8}$ O.D. tube	500 psig 34 bar	2	8	20.3
71912	x			12	30.5
71918	$\frac{1}{8}$ O.D. tube			18	45.7

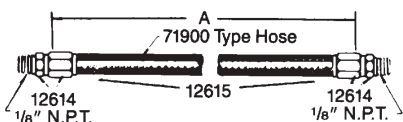

Series 82238

Model No.	Connections in.	Working Pressure	Min. Bend Radius in.	Length "A"	
				in.	cm
82238-12	$\frac{1}{8}$ NPTF (M)	500 psig 34 bar	2	12	30.5
82238-18	x			18	45.7
82238-24	$\frac{1}{8}$ O.D. tube			24	61

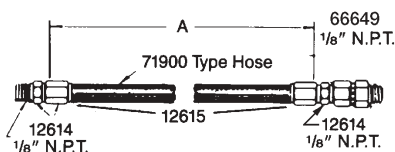

Series 81712

Model No.	Connections in.	Working Pressure	Min. Bend Radius in.	Length "A"	
				in.	cm
81712-6	$\frac{1}{8}$ NPTF (M) x #66649 Adapter Union $\frac{1}{8}$ NPTF (M)	500 psig 34 bar	2	6	15.2
81712-8				8	20.3
81712-12				12	30.5
81712-18				18	45.7
81712-24				24	61
81712-30				30	76.2
81712-36	36	91.4			

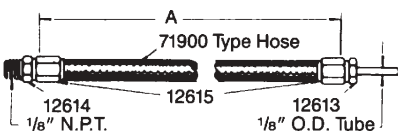

Series 82239

Model No.	Connections in.	Working Pressure	Min. Bend Radius in.	Length "A"	
				in.	cm
82239-12	$\frac{1}{8}$ O.D. tube	500 psig 34 bar	2	12	30.5
82239-18	x			18	45.7
82239-24	$\frac{1}{8}$ NPTF (M)			24	61

Bulk Feed Line Hose and Fittings

Cut to required length and install connector fittings with standard wrenches.
SAE 30R3 type hose. Temperature range -40°F to 212°F.

Bulk Type 71900 Hose

Model No.	Size		Working Pressure	Min. Bend Radius in.	Length ft. / m
	I.D. in.	O.D. in.			
66844	3/16	3/8	500 psig / 34 bar	2	25 / 7.6
71900					Specify length

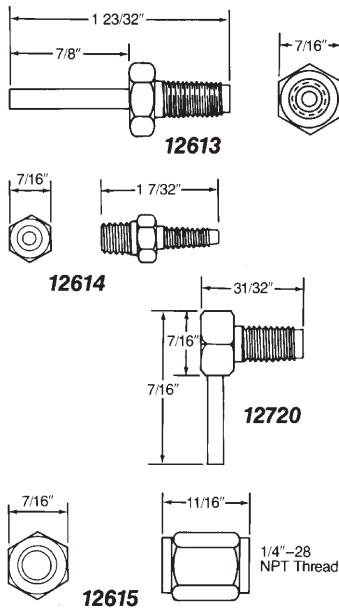

Fittings for 71900 Hose

Part No.	Construction	Description	Size - in.
12613	Steel	Hose Stud	1/4 O.D. tube x 1/4 -28 male
12614			1/8 NPT male x 1/4 -28 male
13003			1/4 -28 male x 1/4 -28 male
12720			1/8 O.D. tube x 1/4 -28 male, 90° angle
12615*		Coupling Nut	1/4 -28 female
12613-9	Type 303 Stainless Steel	Hose Stud	1/8 O.D. tube x 1/4 -28 male
12614-9			1/8 NPT male x 1/4 -28 male
12615-9*			Coupling Nut

* One coupling nut required for each hose stud.

Air Hose

Connect system to compressed air supply.

Model No.	Length ft.	Specifications			Maximum Pressure		Braid												
		I.D. in.	O.D. in.	Thread in.	Working	Burst													
72024 72036 72060 72120 72240 72480 72600	2 3 5 10 20 40 50	1/4	5/8	1/4 NPT male	250 psig 17 bar	1250 psig 85 bar	2-Ply Rayon												
72024A 72060A 72240A 72360A 72480A 72600A 72720A	2 5 20 30 40 50 60							3/8	23/32	3/8 NPT male	250 psig 17 bar	1250 psig 85 bar	2-Ply Rayon						
74024 74060 74480 74600	2 5 40 50													1/2	27/32	1/2 NPT male	200 psig 14 bar	800 psig 55 bar	1-Ply Rayon

Kits for Hose Repair—Reusable Splicers

If hose damage is not near end, cut off bad section and install reusable splicer.

Model	For Hose	Type Hose	Working Pressure
80373	1/4" ID—5/8" OD	72	250 psig / 17 bar



Heavy Duty Air Line Quick Disconnects

Rugged, high flow industrial design steel couplers and nipples.

For 1/4" I.D. Hose			
Model	Description	Size	Max. Air Pressure
633102	Nipple	1/8" NPT M	300 psig 20 bar
633104	Nipple	1/4" NPT M	
For 3/8" I.D. Hose			
Model	Description	Size	Max. Air Pressure
645006	Coupler	3/8" NPT F	300 psig / 20 bar
For 1/2" I.D. Hose			
Model	Description	Size	Max. Air Pressure
655008	Coupler	1/2" NPT F	300 psig 20 bar
655012	Coupler	3/4" NPT F	
653108	Nipple	1/2" NPT M	
653112	Nipple	3/4" NPT M	
For 3/4" I.D. Hose			
Model	Description	Size	Max. Air Pressure
662012	Coupler	3/4" NPT F	300 psig 20 bar
660112	Nipple	3/4" NPT M	

Pipe Fittings—Reducing Bushings

For supply and feed lines.

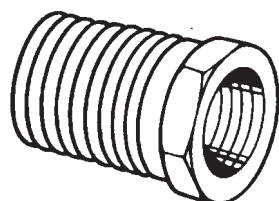

Model No.	Thread / in.	Construction
10461	1/8 NPTF female x 1/4 NPTF male	Steel
10200	1/8 NPTF female x 1/2-27 NPTF male	Brass
11229	1/4 NPTF female x 1/8 NPTF male	Steel
11348	1/4 NPTF female x 1/4 NPTF male	Steel
20011	1/4 NPTF female x 3/8 NPTF male	Steel
12080	1/4 NPTF female x 1/2 NPTF male	Steel
10204	1/4 NPTF female x 1/2-27 NPTF male	Brass
10049	3/8 NPTF female x 1/4 NPTF male	Steel
67365	3/8 NPTF female x 1/4 NPTF male	Brass
67069	3/8 NPTF female x 1/2 NPTF male	Steel
67198	3/8 NPTF female x 3/4 NPTF male	Steel
12896	3/8 NPTF female x 1 NPTF male	Steel
10201	7/16-27 NPTF female x 1/2-27 NPTF male	Brass
12989	1/2 NPTF female x 1/4 NPTF male	Steel
67171	1/2 NPTF female x 3/4 NPTF male	Steel
12287	1/2-27 NPTF female x 1/2 NPTF male	Steel
67302	3/4 NPTF female x 1 NPTF male	Steel
67391	1 NPTF female x 1 1/4 NPTF male	Steel

Pipe Fittings—Nipples

For supply and feed lines.

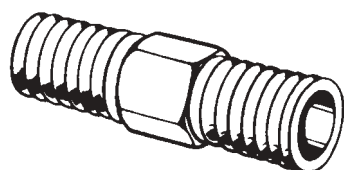

Model No.	Thread / in.	Style	Construction
10130	1/8 NPTF male x 1/8 NPTF male	Hex	Steel
10130-9	1/8 NPTF male x 1/8 NPTF male	Hex	Stainless Steel-30
67371	1/8 NPTF male x 1/8 NPTF male	Close	Brass
10772	1/8 NPTF male x 1/4 NPTF male	Hex	Steel
10199	1/8 NPTF male x 1/2-27 NPTF male	Hex	Brass
10462	1/4 NPTF male x 1/4 NPTF male	Hex	Steel
10462-9	1/4 NPTF male x 1/4 NPTF male	Hex	Stainless Steel-303
10198	1/4 NPTF male x 1/2-27 NPTF male	Hex	Brass
10773	3/8 NPTF male x 1/4 NPTF male	Hex	Steel
14727	3/8 NPTF male x 1/4 NPTF male	Hex	Steel
10540	3/8 NPTF male x 1/2 NPTF male	Hex	Steel
11107	3/8 NPTF male x 3/4 NPTF male	Hex	Steel
11197	1/2-27 NPTF male x 1/2 NPTF male	Hex	Steel
12957	1/2 NPTF male x 1/2-27 NPTF male	Hex	Steel
12106	1/2 NPTF male x 1/4 NPTF male	Hex	Steel
10202	1/2-27 NPTF male x 1/2-27 NPTF male	Hex	Brass

Pipe Fittings—Couplings

For supply and feed lines.

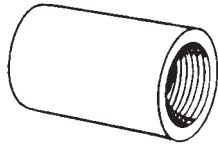

Model No.	Thread / in.	Construction
67063	1/8 NPTF female x 1/8 NPTF female	Steel
67360	1/8 NPTF female x 1/8 NPTF female	Brass
67340	1/4 NPTF female x 1/4 NPTF female	Steel
67179	1/2 NPTF female x 1/2 NPTF female	Forged Steel

Pipe Fittings—Reducing Couplings

For supply and feed lines.

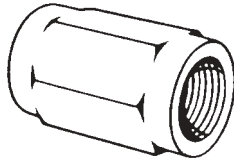

Model No.	Thread / in.	Construction
11852	1/8 NPTF female x 1/2-27 NPTF female	Steel
67094	1/4 NPTF female x 3/8 NPTF female	Malleable Iron
67176	1/4 NPTF female x 1/2 NPTF female	Forged Steel
10522	1/4 NPTF female x 1/2-27 NPTF female	Brass
67296	3/8 NPTF female x 1/2 NPTF female	Forged Steel

Pipe Fittings—Street Elbs

For supply and feed lines.

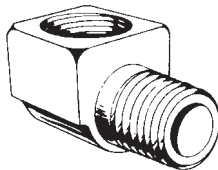

Model No.	Thread / in.	Construction
67368	1/8 NPTF female x 1/8 NPTF male	Brass
67368-9	1/8 NPTF female x 1/8 NPTF male	Stainless Steel-304
67054	1/4 NPTF female x 1/4 NPTF male	Brass
67358	3/8 NPTF female x 3/8 NPTF male	Brass
67074	1/2 NPTF female x 1/2 NPTF male	Malleable Iron
67062	3/4 NPTF female x 3/4 NPTF male	Malleable Iron

Pipe Fittings—Tees

For supply and feed lines.

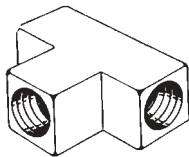

Model No.	Thread / in.	Construction
67011	1/8 NPTF female x 1/8 NPTF male	Brass
67102	1/4 NPTF female x 1/4 NPTF male	Brass
67102-9	1/4 NPTF female x 1/4 NPTF male	Stainless Steel-304
243373	1/2 NPTF female x 1/2 NPTF male	Forged Steel
67041	1/2 NPTF female x 1/2 NPTF male	Malleable Iron
67375	3/4 NPTF female x 3/4 NPTF male	Forged Steel

Pipe Fittings—Crosses

For supply and feed lines.

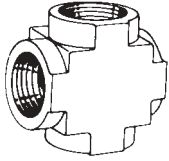

Model No.	Thread / in.	Construction
67362	1/8 NPTF	Brass

Pipe Fittings—Adapter Unions

For supply and feed lines.

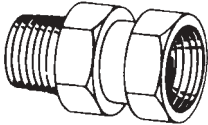

Model No.	Thread / in.	Construction
66649	1/8 NPSM* female swivel x 1/8 NPTF male	Steel
66645	1/4 NPSM* female swivel x 1/4 NPTF male	Steel
66642	3/8 NPSM* female swivel x 3/8 NPTF male	Steel
66883	1/2 NPSM* female swivel x 1/2 NPTF male	Steel
66895	3/4 NPTF female swivel x 3/4 NPTF female	Steel
69375	1 NPTF female swivel x 1 NPTF male	Steel

Pipe Fittings—Elbows

For supply and feed lines.

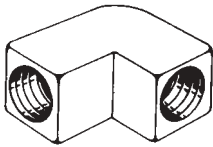

Model No.	Thread / in.	Construction
67103	1/4 NPTF female x 1/4 NPTF female	Brass
67103-9	1/4 NPTF female x 1/4 NPTF female	Stainless Steel-304

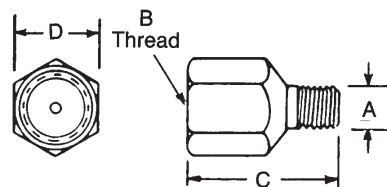

Pipe Fittings—Straight Adapters

For supply and feed lines. Carbon steel.

Model No.	A in.	B in.	C in.	D in.
20024	1/4-28	1/8 NPSF	7/8	1/2
66648	5/16-24	1/8 NPTF	31/32	9/16

Metric

Model No.	A in.	B in.	C in.	D in.
103307E	M6 x 1	1/4-28	.56	.393/.472*
103308E	M8 x 1			
103309E	M10 x 1			

* Hex material may vary.

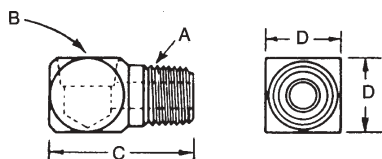

Pipe Fittings—90° Adapters

For supply and feed lines. Carbon Steel.

Model No.	A in.	B in.	C in.	D in.
20026	1/4-28	1/8 *	13/16	1/2
20029	1/8 *	1/8 **	1	1/2
20031	1/8 *	1/8 *	13/16	1/2
20012	1/4 *	1/4 NPTF	15/16	11/16

* PTF special extra short. ** SAE short.

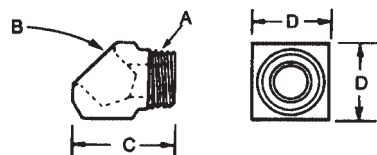

Pipe Fittings—45° Adapters

For supply and feed lines. Carbon Steel.

Model No.	A in.	B in.	C in.	D in.
20028	1/8 **	1/8 **	1	1/2
247616	1/4-28	1/8 *	11/16	1/2

* PTF special extra short. ** SAE short.

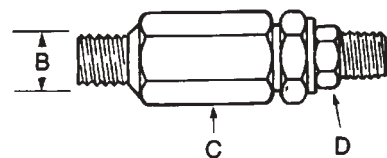

Supply Line Swivels—Straight Swivels (one swivel section)

For lubricant supply lines. Swivels have steel bodies and nitrile packing.

Part No.	A (in.)	B (in.)	C (in.)	D (in.)	Working Pressure
82080	1/2-27	1/2-27	7/8	9/16	5,000 psig 340 bar
83938	1/4 NPTF	1/4 NPTF	7/8	9/16	
81728	3/8 NPTF	1/2 NPTF	1 1/4	1 1/16	
82071	1/2-27	1/2 NPTF	1 1/4	7/8	
82072	1/2 NPTF	1/2 NPTF	1 1/4	7/8	

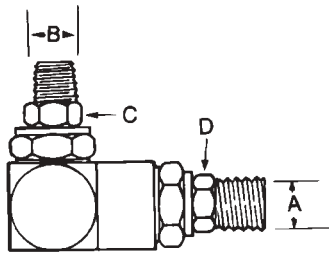

Supply Line Swivels—90° Angle Swivels (one swivel section)

For lubricant supply lines. Swivels have steel bodies and nitrile packing.

Part No.	A in.	B in.	C in.	D in.	Working Pressure
81386	1/8 NPTF	1/2-27	9/16	7/16	5,000 psig 340 bar
81723	1/8 NPTF	1/8 NPTF	5/8	7/16	
81974	1/2-27	1/4 NPTF	9/16	9/16	
82251	1/8 NPTF	1/8 NPTF	7/16	7/16	
82087	1/2 NPTF	1/2 NPTF	7/8	7/8	

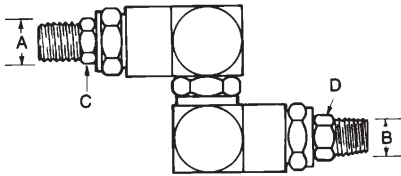

Supply Line Swivels—Universal Swivels (three swivel sections)

For lubricant supply lines. Swivels have steel bodies and nitrile packing.

Part No.	A in.	B in.	C in.	D in.	Working Pressure
82252	1/8 NPTF	1/8 NPTF	7/16	7/16	5,000 psig 340 bar
81387	1/4 NPTF	1/2-27	9/16	9/16	
83594	1/4 NPTF	1/4 NPTF	9/16	9/16	
81729	1/2 NPTF	3/8 NPTF	7/8	1 1/16	
82073	1/2 NPTF	1/2 NPTF	7/8	7/8	

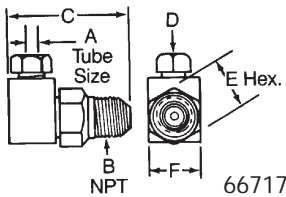

66717

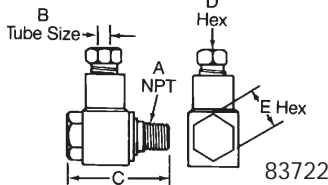

83722

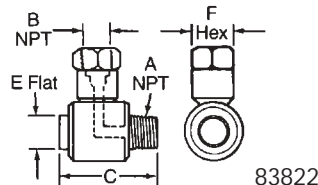

83822

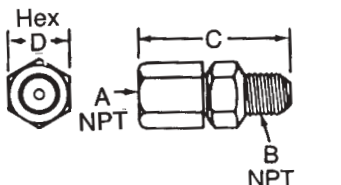

91308

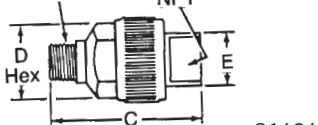

81606

Feed Line Swivels—90° Angle Swivels

For lubricant feed lines. All models have a single swivel section and Buna N seals unless noted otherwise.

Model No.	A Inlet in.	B Outlet in.	C Length in.	D Hex in.	E Hex/Flat in.	F Flat in.
66717	1/8 O.D.	1/8	1 1/4	5/16	9/16	1/2
*66717-9	Tube	NPTF (M)				
91048	1/8	1/8	1 1/4	N/A	9/16	1/2
*91048-9	NPTF (F)	NPTF (M)				
*83722	1/8 O.D. Tube	1/4 -28	1 5/16	1 5/16	3/8	
83822	1/8 NPTF (F)	1/8 NPTF (F)	1 3/8	1/2	3/8	

* 303 Stainless Steel

Note: Models 91048 & 91048-9 are similar in appearance to 66717 & 66717-9, but do not include direct tube connections.

Feed Line Swivels—Straight Swivels

For lubricant feed lines. All models have a single swivel section and Buna N seals unless noted otherwise.

Part No.	A Thread in.	B Thread in.	C Length in.	D Hex in.	E Flat in.
91308	1/8	1/8	1 3/8	9/16	
*92131	NPTF (F)	NPTF (M)			
81606	1/8 NPTF (F)	1/8 NPT (M)	1 1/2	3/4	1 5/32

* With Viton seals.

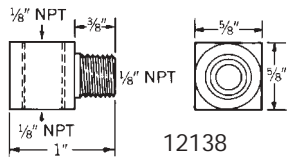

12138

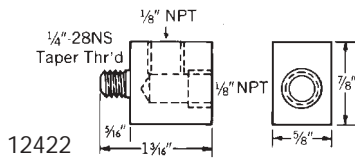

12422

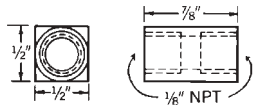

12612

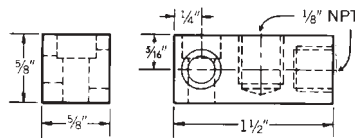

81583

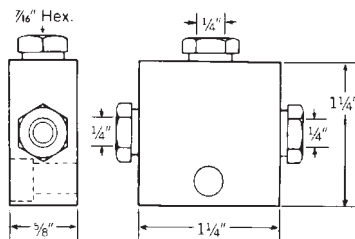

82225

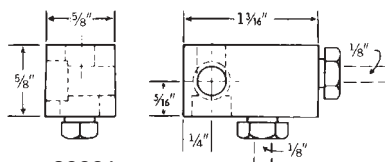

82226

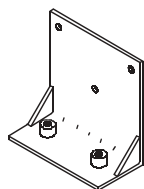

249520

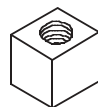

270928



249851



249850

Anchor and Junction Blocks

Securely fasten flexible supply and feed lines.

Part No.	Description	Use with Series Injectors*	Installation Method
12138	Anchor Block	SL-1, 11, 32, 33, 41, 42, 43, 44	Use 1/2" drill and 1/8" NPT tap
12422		SL-1, 11, 32, 33, 41, 42, 43, 44	Use No. 3 drill and 1/4 -28 tap
12612		SL-1, 11, 32, 33, 41, 42, 43, 44	Mounting screw not required
81583**		SL-1, 11, 32, 33, 41, 42, 43, 44	Use No. 7 drill and 1/4 -20 tap
82226**		SL-32, 33, 42, 43	Use No. 7 drill and 1/4 -20 tap
82225**	Junction Block	SL-32, 33, 42, 43	Use No. 7 drill and 1/4 -20 tap

* Can also be used with corresponding size supply and feed lines on Modular Lube II and Quicklub systems.

** Includes 50521 mounting screw.

Anchor and Junction Blocks

Securely fasten flexible supply and feed lines.

Part No.	Description	Installation Method
252807	Divider Valve Mounting Block	Use No. 249987 grade 8 6mm bolt
249520	203 Mounting Bracket Assy	Use No. 249209 grade 8 12mm bolt
249850	12mm Stand-Off	Use No. 249848 grade 8 12mm bolt
249851	1mm Stand-Off	Use No. 249849 grade 8 10mm bolt
270928	12mm Square Stand-Off	Use No. 249848 grade 8 12mm bolt



Modular Air Line Filters

Model No.	Maximum Air Supply	Operating Temperature Range	Material of Construction		Element	
			Body	Bowl	Material	Particle Size
602104	250 psig 17 bar	0° to 150°F	Zinc	Zinc*	Sintered Polypropylene	40µ
602106		-18° to 65°C				
602108		0° to 175°F	Aluminum	Aluminum*		
602109	-18° to 79°C					

* Transparent nylon liquid level indicator lens.

Model No.	Drain Type	Port Size PTF	Dimensions - in. / mm				Weight lbs. / kg
			A	B	C	Dia.	
602104	Manual	¼	5.27	0.75	1.98	1.91	1.1
602106		⅜	1.34	19	50	48	0.5
602108		½	6.95 / 177	1.00	3.15	2.89	1.8
602109	Automatic	½	6.35 / 161	25	80	74	0.8



Modular Air Line Regulators

Model No.	Maximum Air Supply	Operating Temperature Range	Material of Construction				Secondary (Gauge) Connections (in.)
			Body	Bonnet	Valve Seals	Bottom Plug	
602004	300 psig 20 bar	0° to 150°F -18° to 65°C	Zinc	Acetal	Brass Nitrile	Acetal	¼ NPT (F)
602005							
602006							
602007		0° to 175°F -18° to 79°C	Aluminum	Aluminum			
602008							
602009							

Model No.	Outlet Pressure Adj. Range	Connections NPT-Female (in.)	Dimensions - in. / mm				Adjuster	Weight lbs. / kg	
			A	B	C	D			
602004	5 to 150 psig	¼	4.0 / 102	1.31	2.0	3.2	T-Handle	0.8	
602005			2.88 / 73				Knob		
602006	0.3 to 4 bar	⅜	4.0 / 102	33	50	83	T-Handle		0.4
602007			2.88 / 73				Knob		
602008	10 to 250 psig 0.7 to 16 bar	½	5.95	1.69	3.15	5.1	T-Handle	1.77	
602009	5 to 150 psig 0.3 to 4 bar		5.0				43		80
			127						

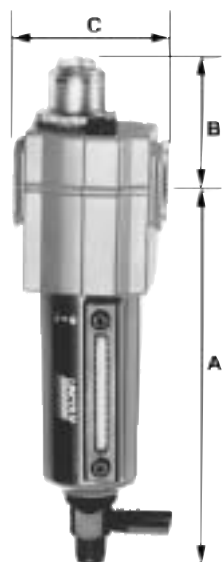

Modular Air Line Lubricators

Model No.	Maximum Air Supply	Operating Temperature Range	Material of Construction			Recommended Lubricants
			Body	Bowl	Sight feed Dome	
602204	250 psig 17 bar	0° to 150°F	Zinc	Zinc*	Transp Nylon	Misting type oil 50 to 200 SSU (ISO Grade 7 to 46) at 100°F (38°C)
602206		-18° to 65°C				
602208		0° to 175°F -18° to 79°C	Aluminum	Aluminum*		

* Transparent nylon liquid level indicator lens.

Model No.	Connections NPT-Female	Bowl Capacity ozs. / ml	Dimensions - in. / mm				Weight lbs. / kg
			A	B	C	D	
602204	¼	2.0	5.27	1.63	1.98	1.91	1.1
602206	⅜	58	134	41	50	48	0.5
602208	½	7.0 207	6.95 177	2.12 53	3.15 80	2.89 74	1.6 0.7

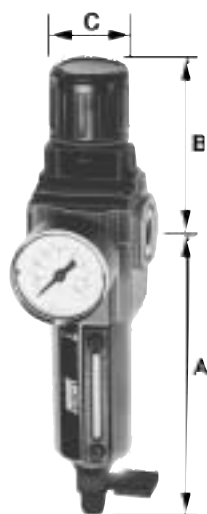

Integrated/Modular Filter/Regulator with Gauge

Can be used with other AirCare Modular Components.

Model No.	Maximum Air Supply	Operating Temperature Range	Element Particle Size	Outlet Pressure Adj. Range
602134	250 psig 17 bar	0° to 150°F	40µ	5 to 150 psig 0.3 to 10 bar
602136		-18° to 65°C		
602138		0.3° to 10°F		
602142		-18° to 79°C		

Model No.	Drain Type	Port Size PTF	Dimensions - in. / mm				Weight lbs. / kg
			A	B	C	D	
602134	Manual	¼	5.27	2.89	1.98	3.29	1.2
602136		⅜	134	73	50	83	0.5
602138		½	6.95	4.98	3.15	5.10	2.6
602142		¾	177	127	80	130	1.2

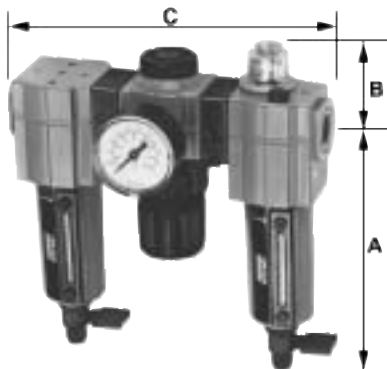

Modular Air Line Combination Units

Filter-Regulator with Gauge-Lubricator

Model No.	Maximum Air Supply	Operating Temperature Range	Element Particle Size	Outlet Pressure Adj. Range	Lubricator Bowl Capacity ozs. / ml
85387-4	250 psig 17 bar	0° to 150°F	40µ	5 to 150 psig 0.3 to 10 bar	2.0
85387-6		-18° to 65°C			58
85387-8		0° to 175°F / -18° to 79°C			7.0 / 207

* Transparent nylon liquid level indicator lens.

Model No.	Drain Type	Port Size PTF	Dimensions - in. / mm			Weight lbs. / kg
			A	B	C	
85387-4	Manual	¼	5.27	1.63	6.46	3.3
85387-6		⅜	134	41	164	1.5
85387-8		½	6.95 / 177	2.12 / 53	10.52 / 267	6.2 / 2.8

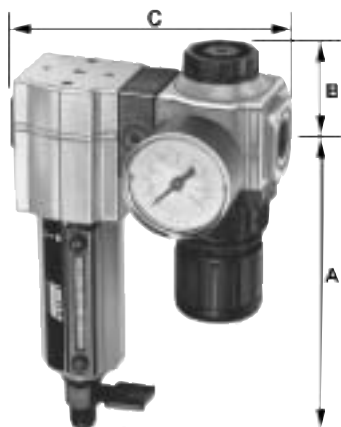

Modular Air Line Combination Units

Filter-Regulator with Gauge

Model No.	Maximum Air Supply	Operating Temperature Range	Element Particle Size	Outlet Pressure Adj. Range
85388-4	250 psig	0° to 150°F / -18° to 65°C	40μ	5 to 150 psig
85388-8	17 bar	0° to 175°F / -18° to 79°C		0.3 to 10 bar

* Transparent nylon liquid level indicator lens.

Model No.	Drain Type	Port Size PTF	Dimensions - in. / mm			Weight lbs. / kg
			A	B	C	
85388-4	Manual	¼	5.27	1.31	4.22	2.1
85388-8		½	6.95 / 177	1.69 / 43	6.84 / 174	4.2 / 2.0



Modular Air Line Combination Units

Filter-Lubricator

Model No.	Maximum Air Supply	Operating Temperature Range	Element Particle Size	Lubricator Bowl Capacity ozs. / ml
85389-4	250 psig 17 bar	0° to 150°F -18° to 65°C	40μ	2.0
85389-6		0° to 175°F / -18° to 79°C		58
85389-8				

* Transparent nylon liquid level indicator lens.

Model No.	Drain Type	Port Size PTF	Dimensions - in. / mm			Weight lbs. / kg
			A	B	C	
85389-4	Manual	¼	5.27	1.63	4.22	2.1
85389-6		¾	134	41	50	1.0
85389-8		½	6.95 / 177	2.12 / 53	6.84 / 174	3.8 / 1.7



High Capacity Air Line Filters

Model No.	Maximum Air Supply	Operating Temperature Range	Material of Construction		Element	
			Body	Bowl	Material	Particle Size
602112	250 psig 17 bar	0° to 175°F -18° to 79°C	Aluminum	Aluminum* w/ Pyrex sight glass	Sintered bronze	50μ
602113						
602116						
602117						

* Pyrex liquid level indicator.

Model No.	Drain Type	Port Size PTF	Dimensions - in. / mm				Weight lbs. / kg
			A	B	C	Dia.	
602112	Manual	¾	10.44 / 265	1.25 32	4.75 121	5.52 140	4.1 1.9
602113	Automatic		10.06 / 256				
602116	Manual	1	10.44 / 265				
602117	Automatic	1	10.06 / 256				

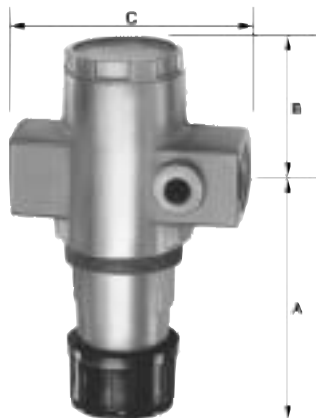

High Capacity Air Line Regulators

Model No.	Maximum Air Supply	Operating Temperature Range	Material of Construction				Secondary (Gauge) Connections (in.)
			Body	Bonnet	Valve Seals	Bottom Plug	
602012	300 psig 20 bar	0° to 175°F -18° to 79°C	Aluminum	Aluminum	Aluminum Nitrile	Aluminum	¼ NPT (F)
602013							
602016							
602017							

Model No.	Outlet Press. Adj. Range psig / bar	Connections NPT-Female in.	Dimensions - in. / mm				Adjuster	Weight lbs. / kg
			A	B	C	D		
602012	10 to 250 / 0.7 to 16	¾	5.69 / 145	2.38 60	4.25 108	2.38 60	T-Handle	2.5 1.1
602013	5 to 150 / 0.3 to 10		4.71 / 120				Knob	
602016	10 to 250 / 0.7 to 16	1	5.69 / 145	T-Handle				
602017	5 to 150 / 0.3 to 10		4.71 / 120	Knob				

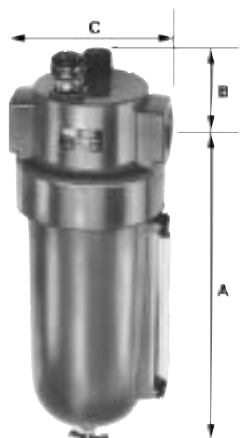

High Capacity Air Line Lubricators

Model No.	Maximum Air Supply	Operating Temperature Range	Material of Construction			Recommended Lubricants
			Body	Bowl	Sight feed Dome	
602212	250 psig 17 bar	0° to 175°F -18° to 79°C	Aluminum	Aluminum*	Transp. Nylon	Misting type oil 50 to 200 SSU (ISO Grade 7 to 46) at 100°F (38°C)
602216						

* Pyrex liquid level indicator.

Model No.	Connections NPT-Female	Bowl Capacity ozs. / ml	Dimensions - in. / mm				Weight lbs. / kg
			A	B	C	Dia.	
602212	¾	32	10.24	2.22	4.50	5.52	3.6
602216	1	946	260	56	114	140	1.6

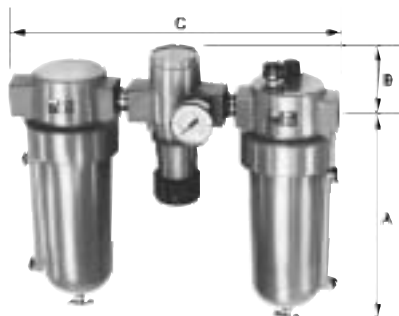

High Capacity Air Line Combination Units

High Capacity Filter-Regulator with Gauge-Lubricator

Model No.	Maximum Air Supply	Operating Temperature Range	Element Particle Size	Outlet Pressure Adj. Range	Lubricator Bowl Capacity ozs. / ml
85387-12	250 psig	0° to 175°F	50µ	5 to 125 psig	32
85387-16	17 bar	-18° to 79°C		0.3 to 8.6 bar	946

* Pyrex liquid level indicator.

Model No.	Drain Type	Port Size PTF	Dimensions - in. / mm			Weight lbs. / kg
			A	B	C	
85387-12	Manual	¾	10.44	2.22	14.75	10.6
85387-16		1	265	56	375	4.8

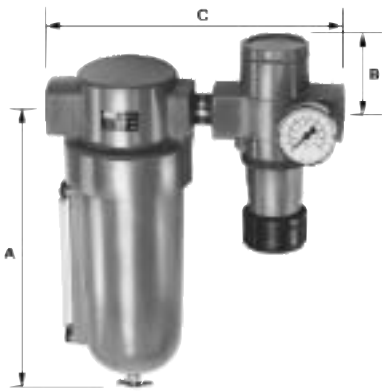

High Capacity Air Line Combination Units

Filter-Regulator with Gauge

Model No.	Maximum Air Supply	Operating Temperature Range	Element Particle Size	Outlet Pressure Adj. Range
85388-12	250 psig	0° to 175°F	50μ	5 to 125 psig 0.3 to 8.6 bar
85388-16	17 bar	-18° to 79°C		

* Pyrex liquid level indicator.

Model No.	Drain Type	Port Size PTF	Dimensions - in. / mm				Weight lbs. / kg
			A	B	C	Dia.	
85388-12	Manual	¾	10.44 265	2.38 60	10 254	5.52 140	6.9 3.1
85388-16		1					



High Capacity Air Line Combination Units

Filter-Lubricator

Model No.	Maximum Air Supply	Operating Temperature Range	Element Particle Size	Lubricator Bowl Capacity ozs. / ml
85389-12	250 psig	0° to 175°F	50μ	32
85389-16	17 bar	-18° to 79°C		946

* Pyrex liquid level indicator.

Model No.	Drain Type	Port Size PTF	Dimensions - in. / mm				Weight lbs. / kg
			A	B	C	Dia.	
85389-12	Manual	¾	10.44 265	2.22 56	10.25 260	5.52 140	7.8 3.5
85389-16		1					



Miniature Air Line Components—Air Line Filter

Model No.	Maximum Air Supply	Operating Temperature Range	Material of Construction		Element	
			Body	Bowl	Material	Particle Size
602103	150 psig 10 bar	0° to 125°F -18° to 52°C	Zinc	Polycarbonate	Porous Polypropylene	50μ

Model No.	Drain Type	Port Size PTF	Dimensions - in. / mm				Weight lbs. / kg
			A	B	C	Dia.	
602103	Manual	¼	3.25 / 83	0.38 / 10	1.63 / 42	1.45 / 37	0.3 / 0.12

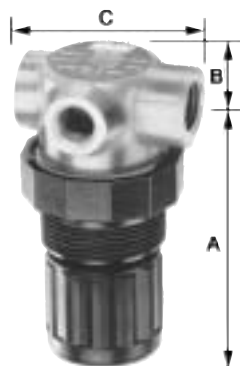

Miniature Air Line Components—Air Line Regulator

Model No.	Maximum Air Supply	Operating Temperature Range	Material of Construction				Secondary (Gauge) Connections-in.
			Body	Bonnet	Valve Seals	Bottom Plug	
602003	300 psig 20 bar	0° to 150°F -18° to 65°C	Zinc	Acetal	Brass/ Nitrile	Acetal	½ NPT (F)

Model No.	Outlet Pressure Adj. Range	Connections NPT-Female in.	Dimensions - in. / mm				Adjuster	Weight lbs. / kg
			A	B	C	D		
602003	5 to 100 psig 0.3 to 7 bar	¼	2.52 64	0.39 10	1.63 41	1.45 37	Knob	0.3 0.13



Miniature Air Line Components—Air Line Lubricator

Model No.	Maximum Air Supply	Operating Temperature Range	Material of Construction			Recommended Lubricants
			Body	Bowl	Sight feed Dome	
602203	150 psig 10 bar	0° to 125°F -18° to 52°C	Aluminum	Poly-carbonate	Transp. Nylon	Misting type oil 50 to 200 SSU (ISO Grade 7 to 46) at 100°F / 38°C

Model No.	Connections NPT-Female in.	Bowl Capacity ozs. / ml	Dimensions - in. / mm				Weight lbs. / kg
			A	B	C	Dia.	
602203	¼	1.0 / 30	3.25 / 83	1.98 / 50	1.63 / 41	1.45 / 37	0.3 / 0.13

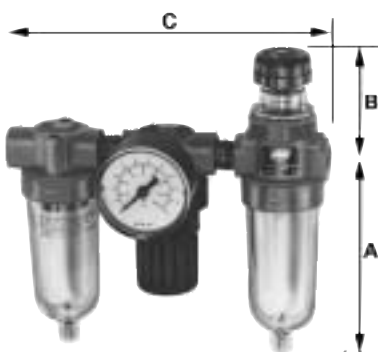

Miniature Air Line Combination Units

Filter-Regulator with Gauge-Lubricator

Model No.	Maximum Air Supply	Operating Temperature Range	Element Particle Size	Outlet Pressure Adj. Range psig / bar	Lubricator Bowl Capacity ozs. / ml
85672	150 psig / 10 bar	0° to 150°F / -18° to 65°C	50µ	5 to 100 / 0.3 to 6.9	1.0 / 30

Model No.	Drain Type	Port Size PTF	Dimensions - in. / mm				Weight lbs. / kg
			A	B	C	Dia.	
85672	Manual	¼	3.25 / 83	1.98 / 50	5.61 / 143	1.45 / 37	1.3 / 0.6

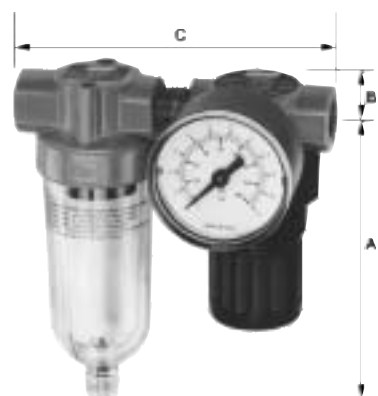

Miniature Air Line Combination Units

Filter-Regulator with Gauge

Model No.	Maximum Air Supply	Operating Temperature Range	Element Particle Size	Outlet Pressure Adj. Range
85673	150 psig / 10 bar	0° to 125°F / -18° to 52°C	5µ	5 to 100 psig / 0.3 to 7 bar

Model No.	Drain Type	Port Size PTF	Dimensions - in. / mm				Weight lbs. / kg
			A	B	C	Dia.	
85673	Manual	¼	3.25 / 83	0.38 / 10	3.66 / 93	1.45 / 37	0.9 / 0.4



Miniature Air Line Combination Units

Filter-Lubricator

Model No.	Maximum Air Supply	Operating Temperature Range	Element Particle Size	Lubricator Bowl Capacity ozs. / ml
85674	150 psig / 10 bar	0° to 125°F / -18° to 52°C	5μ	1.0 / 30

Model No.	Drain Type	Port Size PTF	Dimensions - in. / mm				Weight lbs. / kg
			A	B	C	Dia.	
85674	Manual	¼	3.25 / 83	1.98 / 50	3.66 / 93	1.45 / 37	0.9 / 0.4

Modular Air Line Equipment Accessories— Lockout Valve

Install in-line or modular with other AirCare products to help conform to OSHA Lockout Regulations. In the closed position, valves block inlet air flow and exhaust downstream air.



Model No.	For Modular use with	For In-Line use with	Maximum Air Supply	Operating Temperature Range
247770	¼" Modular	¼"	250 psig 17 bar	0° to 150°F -20° to 65°C
247771	⅜" Modular	⅜"		
247772	½" Modular	½"		
247773	¾" Modular	¾"		

Modular Air Line Equipment Accessories— Quick Clamp

Use with Modular Air Line Components to provide modular installation capability. Flanges on the products slide into "V" grooves in the quick clamp. Two face-sealing o-rings in the quick clamp provide an air tight connection when the clamp is closed.



Model No.	For Modular Sizes	Dimensions in. / mm
247782	¼" and ⅜"	1.50 / 38
247783	½" and ¾"	2.00 / 51

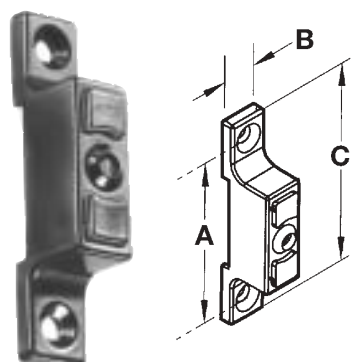

Modular Air Line Equipment Accessories— Quick Clamp Wall Mounting Bracket

Use with quick clamp to provide secure mounting to a wall, machine panel, or other flat surface.

Model No.	For Modular Sizes	Dimensions in. / mm		
		A	B	C
247792	¼" and ⅜"	2.32 / 59	0.55 / 14	2.91 / 74
247793	½" and ¾"	3.25 / 83	0.95 / 24	4.0 / 102



Modular Air Line Equipment Accessories— Porting Block

Installs between the quick clamps to provide three additional ¼" outlets for auxiliary air.

Model No.	For Modular Sizes
247784	¼" and ⅜"



Modular Air Line Equipment Accessories— Quick Mount Pipe Adaptors

Use with quick clamp to provide threaded connections to the system piping.

Model No.	For Modular use with	Port Size - in.
247786	¼" and ⅜" Modular	¼
247787		⅜
247789	½" and ¾" Modular	⅜
247790		½
247791		¾

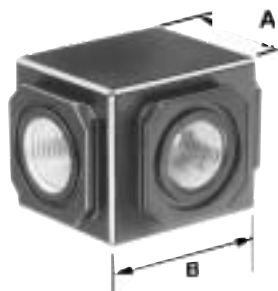

Modular Air Line Equipment Accessories— Manifold Block

Installs with quick clamps. Ports are threaded pipe to provide manifolding capability for up to three components.

Model No.	Port Size-in.	For Modular Sizes	Dimensions-in. / mm	
			A	B
247794	⅜	¼" and ⅜"	1.76 / 44.6	1.98 / 50.3
247795	¾	½" and ¾"	2.27 / 57.8	3.15 / 80

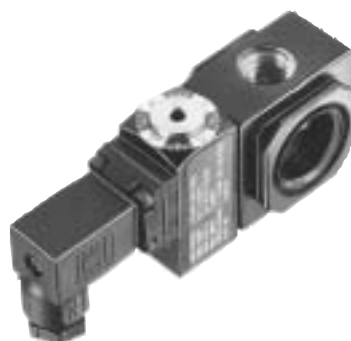

Modular Air Line Equipment Accessories— Pressure Switch

Monitors air pressure and provides an electrical signal when the pressure drops below or exceeds the preset pressure. Installs between two quick clamps. Also provides three additional ¼" auxiliary outlets.

Model No.	For Modular Sizes	Maximum Inlet Pressure	Operating Temperature Range	Adjustment Range
247796	¼" and ⅜"	250 psig 17 bar	0° to 150°F -20° to 65°C	30 to 150 2 to 10



Modular Air Line Equipment Accessories— Panel Nut

Use to panel mount Regulators and Filter/Regulators.

Model No.	For Modular Sizes
247780	¼" and ⅜"



Modular Air Line Equipment Accessories— Tamper Resistant Cover & Seal Wire

Install on the adjusting knob of regulators to help prevent unauthorized adjustment of the pressure setting.

Model No.	For Modular Sizes
247778	½" and ¾"



Modular Air Line Equipment Accessories— Wall Mount Bracket

Use to secure Modular Air Line components to a wall, machine panel, or other flat surface.

Model No.	For Modular Sizes
247775	¼" and ⅜"
247776	½" and ¾"



Air Line Equipment Accessories— Wall Mount Bracket-High Capacity

Use to secure High Capacity Air Line components to a wall, machine panel, or other flat surface.

Model No.	Component
247798	All Regulators
247799	All Filters and Lubricators



Air Line Equipment Accessories— Mounting Bracket and Nut-Miniature

Use to secure Miniature Air Line components to a wall, machine panel, or other flat surface.

Model No.	Component
247774	All Regulators and Lubricators



Air Line Equipment Accessories— Pressure Gauges

Available in 1/8" NPT and 1/4" NPT back connection.

Model No.	For Regulator Sizes	Gauge Dia.	Connection	Pressure Range
247843	1/4" and 3/8"	1 1/2"	1/8" NPT	0 to 160 psig / 0 to 11bar
247844	1/2", 3/4" and 1"	2"	1/4" NPT	
247863				0 to 300 psig / 0 to 20 bar



Manual Shut-Off Valves—High Pressure Needle Valves

For supply lines.

Model No.	Inlet/Outlet Female (in.) NPTF (F)	Dimension		Maximum Working Pressure
		A (Valve Open) in. / cm	B in. / cm	
778	¼	3½ / 7.8	2½ / 6.4	10000 psig 680 bar
884	⅜	3¾ / 9.5	2⅞ / 7.3	
885	½	3¾ / 9.5	2⅞ / 7.3	
886	¾	5¼ / 13.3	4¼ / 10.8	
887	1	5⅞ / 14.9	4¼ / 10.8	



Manual Shut-Off Valves—Quarter Turn Valves

For supply lines.

Model No.	Connections NPTF-Female in.	Dimension - in. / cm		Maximum Working Pressure
		A	B	
69503	½	6½ / 15.3	1⅞ / 4.1	2000 psig 136 bar
69425	¾	6⅝ / 15.6	2⅞ / 7.3	
69423	1	7⅞ / 19.3	4¼ / 10.8	
69422	1½	10⅞ / 25.7	4¼ / 10.8	



Manual Shut-Off Valves—Low Pressure Valve

Model No.	Inlet/Outlet in.	Maximum Working Pressure
68042	⅜ NPTF (F) x ½ NPTF (M)	150 psig / 10 bar



Manual Shut-Off Valves—Low Pressure Quarter Turn Valves

Model No.	Inlet/Outlet NPTF (F) in.	Maximum Working Pressure
66084	½	710 psig / 48 bar
70332	¾	600 psig / 41 bar
256200	¼	300 psig / 20 bar



Pressure Gauges—High Pressure Gauges

For lubricant supply lines.

Model No.	Maximum Register	Indicator Needle	Dial Diameter in. / mm	Connection	
				Size in.	Location
66689	2000 psig	Single	2½ 63.5	¼ NPT(M)	Bottom
68946	140 kg/cm²	Dual			
69844	3000 psig	Single	3½ / 88.9		Back Center
69827	210 kg/cm²				Bottom
66111	5000 psig / 350 kg/cm²	Single	3½ / 88.9		
66050	10,000 psig 700 kg/cm²	Single	3½ / 88.9		



Pressure Gauges—Low Pressure Gauges

For air lines.

Model No.	Maximum Register	Indicator Needle	Dial Diameter in.	Connection	
				Size in.	Location
66100	200 psig	Single	2	¼ NPT(M)	Bottom
600401	14 kg/cm ²				Back Center



Lubricant Filters

Remove solid contaminants before delivering lubricants to the supply line. Filters mount in pump outlet before vent valve on reciprocating pump systems.

Model No.	Element Size micron	Maximum Pressure	Connections in.	Hex Body Size - in.
84004	140	5000 psig / 340 bar	½ NPTF (M)	¼
84528	420			
*84239	10	6000 psig / 408 bar	¼ NPTF (F)	1¼

* In-line filter with Viton seal.

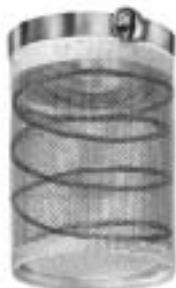

Lubricant Strainers

Remove solid contaminants before delivering lubricants to the supply line. Strainers mount at pump inlet.

Model No.	Use with Pump/Model Type	Strainer Size
82103	Series 20 Models 1823/282288	500 Micron

Note: Not recommended for use with heavy lubricants.

Decimal Equivalents

Fraction	Decimal - in.	mm	Fraction	Decimal - in.	mm
1/64	.01563	.40	33/64	.51563	13.1
1/32	.03125	.80	17/32	.53125	13.5
3/64	.04687	1.2	35/64	.54688	13.9
1/16	.0625	1.6	9/16	.56250	14.3
5/64	.07813	2.0	37/64	.57813	14.7
3/32	.09375	2.4	19/32	.59375	15.1
7/64	.10937	2.8	39/64	.60938	15.5
1/8	.125	3.2	5/8	.625	15.9
9/64	.14063	3.6	41/64	.64063	16.3
5/32	.15625	4.0	21/32	.65625	16.7
11/64	.17188	4.4	43/64	.67188	17.1
3/16	.1875	4.8	11/16	.6875	17.5
13/64	.20313	5.2	45/64	.70313	17.9
7/32	.21875	5.6	23/32	.71875	18.3
15/64	.23438	6.0	47/64	.73438	18.7
1/4	.25	6.4	3/4	.750	19.1
17/64	.26563	6.7	49/64	.76563	19.4
9/32	.28125	7.1	25/32	.78125	19.8
19/64	.29688	7.5	51/64	.79688	20.2
5/16	.3125	7.9	13/16	.8125	20.6
21/64	.32813	8.3	53/64	.82813	21.0
11/32	.34375	8.7	27/32	.84375	21.4
23/64	.35938	9.1	55/64	.85938	21.8
3/8	.375	9.5	7/8	.875	22.2
25/64	.39063	9.9	57/64	.89063	22.6
13/32	.40625	10.3	29/32	.90625	23.0
27/64	.42188	10.7	59/64	.92188	23.4
7/16	.4375	11.1	15/16	.9375	23.8
29/64	.45313	11.5	61/64	.95313	24.2
15/32	.46875	11.9	31/32	.96875	24.6
31/64	.48438	12.3	63/64	.98138	25.0
1/2	.50	12.7	1	1.0000	25.4

Note:

1 inch = 25.4 millimeters

To convert decimals to millimeters multiply by 25.4

Example: 1/4" = .250"

.250" x 25.4 = 6.35 mm

To convert millimeters to decimals, divide by 25.4

Example: 6.35 mm ÷ 25.4 = .250" = 1/4"

Part No.	Page No.	Part No.	Page No.	Part No.	Page No.	Part No.	Page No.
G904	.12	5200C	.20	12080	.35	62950-9	.22
G905	.12	5210	.4, 21	12106	.35	64532-1	.19, 23
12D	.24	5210-9	.9, 21	12138	.40	64532-2	.19, 23
15	.24	5210C	.20	12287	.35	64532-3	.19, 23
17	.25	5300	.5, 21	12422	.40	64532-4	.19, 23
778	.51	5300C	.20	12511	.11	64532-5	.19, 23
884	.51	5308	.5, 21	12612	.40	64533-1	.18, 23
885	.51	5318	.8, 21	12613	.33	64533-2	.18, 23
886	.51	5350	.6, 21	12613-9	.33	64533-3	.18, 23
887	.51	5350C	.20	12614	.33	64533-4	.18, 23
1823	.25	5385	.8, 21	12614-9	.33	64533-5	.18, 23
5000	.5, 21	5385C	.20	12615	.33	66050	.51
5000-1	.5, 21	5400	.5, 21	12615-9	.33	66084	.51
5000-9	.9, 21	5400C	.20	12720	.33	66100	.52
5000C	.20	5410	.4, 21	12896	.35	66111	.51
5003	.5, 21	5410-9	.9, 21	12957	.35	66200	.17, 26
5003C	.20	5410C	.20	12989	.35	66201	.17, 26
5009	.5, 21	5505	.5, 21	13003	.33	66202	.19, 23
5010	.4, 21	5527	.4, 21	13112	.18, 29	66202-9	.23
5010-1	.4	5527C	.20	13129	.11	66210	.26
5010-9	.9, 21	5677	.10, 21	13147	.14	66211	.26
5010C	.20	5678	.10, 21	13148	.14	66260	.17, 28
5013	.4, 21	5679	.10, 21	13154	.11, 16, 21	66260-9	.28
5013C	.20	5680	.10, 21	13155	.11, 16, 21	66414	.17, 28
5014	.4, 21	5698	.10, 21	14054	.11, 16	66415	.17, 28
5031	.8, 21	5701	.10, 21	14562	.14	66495	.23
5031C	.20	5701C	.20	14563	.14	66642	.37
5033	.8, 21	5706	.10, 21	14564	.14	66645	.37
5033C	.20	5706C	.20	14570	.14	66648	.38
5033-9	.9, 21	5711	.10, 21	14727	.35	66649	.16, 37
5036	.8, 21	10049	.35	14771	.14	66650	.27
5045	.10, 21	10130	.35	14772	.14	66651	.26
5050	.6, 21	10130-9	.35	20011	.16, 35	66689	.51
5050C	.20	10182	.11	20012	.38	66713	.18, 28, 29
5099	.10, 21	10198	.35	20024	.11, 16, 21, 38	66714	.17, 28
5175	.6, 21	10199	.35	20026	.11, 21, 38	66714-9	.28
5175C	.20	10200	.35	20028	.11, 21, 38	66716	.17, 28
5176	.6, 21	10201	.35	20029	.11, 21, 38	66717	.16, 17, 39
5176C	.20	10202	.35	20031	.11, 21, 38	66717-9	.39
5177	.6, 21	10204	.35	50057	.15	66730	.28
5177C	.20	10461	.35	50521	.40	66762	.26
5178	.6, 21	10462	.35	51026	.15	66771	.28
5178C	.20	10462-9	.35	51055	.16	66772	.28
5179	.6, 21	10522	.36	51304	.15	66773	.28
5179C	.20	10540	.35	62175	.15, 22	66844	.33
5180	.6, 21	10772	.35	62176	.15, 22	66846	.26
5180C	.20	10773	.35	62249	.22	66872	.23
5181	.6, 21	11107	.35	62256	.22	66872-9	.23
5181C	.20	11197	.35	62278	.22	66876	.26
5182	.6, 21	11229	.35	62357	.15, 22	66878	.27
5182C	.20	11348	.35	62956	.22	66883	.37
5183	.6, 21	11485	.12	62711	.22	66895	.37
5183C	.20	11509	.12	62948-9	.22	66935	.28
5200	.5, 21	11852	.36	62949-9	.22	67011	.36

Part No.	Page No.	Part No.	Page No.	Part No.	Page No.	Part No.	Page No.
67041	36	69072	24	72240	33	81712-36	32
67054	36	69073	24	72240A	33	81723	39
67062	36	69077	24	72360A	33	81728	38
67063	36	69078	24	72480	33	81729	39
67069	35	69079	24	72480A	33	81974	39
67074	36	69079-9	24	72600	33	82071	38
67094	36	69080	24	72600A	33	82072	38
67102	36	69081	24	72720A	33	82073	39
67102-9	36	69082	24	73036	31	82080	38
67103	37	69082-9	24	73060	31	82087	39
67103-9	37	69083	24	73120	31	82092	28
67132	16	69084	25	73240	31	82093	28
67171	35	69085	25	73360	31	82103	52
67176	36	69089	25	73480	31	82225	40
67179	36	69093	25	73600	31	82226	40
67198	35	69094	25	73900	31	82238	32
67296	36	69094-9	25	74024	33	82238-12	32
67302	35	69095	25	74060	33	82238-18	32
67340	36	69095-9	25	74480	33	82238-24	32
67358	36	69096	25	74600	33	82239	32
67360	36	69097	25	75024	31	82239-12	32
67362	37	69098	25	75036	31	82239-18	32
67365	35	69099	25	75060	31	82239-24	32
67368	36	69099-9	25	75084	31	82251	39
67368-9	36	69100	25	75120	31	82252	39
67371	35	69101	25	75168	31	82617	18, 29
67372	26	69101-9	25	75240	31	82618	18, 29
67374	27	69159-9	23	75360	31	83594	39
67375	36	69161-9	23	75480	31	83722	39
67391	35	69163-9	23	75600	31	83822	39
68042	51	69164-9	23	75936	31	83938	38
68412	26	69165-9	23	75948	31	84004	52
68414	26	69166-9	26	75960	31	84239	52
68415	26	69169-9	23, 26	76024A	31	84528	52
68462	17, 27	69170-9	27	76024B	31	85387-4	48
68463	27	69171-9	27	76600A	31	85387-6	48
68464	17, 27	69375	37	76600B	31	85387-8	48
68465	27	69422	51	76900B	31	85387-12	50
68468	27	69423	51	78024	31	85387-16	50
68510	19	69425	51	78600	31	85388-4	49
68511	19	69503	51	79060	31	85388-8	49
68535	19	69827	51	79120	31	85388-12	51
68615	26	69844	51	80373	34	85388-16	51
68943	26	70332	51	81386	39	85389-4	49
68946	51	71900	32, 33	81387	39	85389-6	49
68987	19	71908	32	81583	40	85389-8	49
69068	24	71912	32	81606	39	85389-12	51
69068-9	24	71918	32	81712	32	85389-16	51
69069	24	72024	33	81712-6	32	85672	52
69069-9	24	72024A	33	81712-8	32	85673	52
69070	24	72036	33	81712-12	32	85674	47
69070-9	24	72060	33	81712-18	32	91048	16, 39
69071	24	72060A	33	81712-24	32	91048-9	39
69071-9	24	72120	33	81712-30	32	91308	16, 39

Part No.	Page No.	Part No.	Page No.	Part No.	Page No.
92131	.39	247787	.48	602206	.48
103307E	.38	247789	.48	602208	.48
103308E	.38	247790	.48	602212	.50
103309E	.38	247791	.48	602216	.50
205000	.7, 21	247792	.47	633102	.34
205010	.7, 21	247793	.47	633104	.34
205200	.7, 21	247794	.48	645006	.34
205210	.7, 21	247795	.48	653108	.34
205400	.7, 21	247796	.48	653112	.34
205410	.7, 21	247798	.50	655008	.34
240646	.4, 21	247799	.50	655012	.34
241054	.19	247843	.50	660112	.34
241055	.19	247844	.50	662012	.34
241056	.19	247863	.50	1230084	.31
241110	.19	249520	.40	1230120	.31
241238	.16	249850	.40	1625084	.31
241285	.15	249851	.40	1625120	.31
241286	.15	249853	.23	226-12508-5	.15
241287	.15	249913	.23	226-13095-7	.15
241288	.15	250475	.17, 29		
241289	.15, 16	252807	.40		
241290	.18	256200	.51		
241293	.18	270784	.17		
241388	.18, 29	270928	.40		
241389	.18, 29	270931	.23		
242025	.15	282288	.52		
242050	.15	360108	.23		
242125	.19	600401	.52		
243373	.36	602003	.52		
243699	.18, 30	602004	.47		
244047	.18, 30	602005	.47		
244048	.18, 30	602006	.47		
244054	.18, 30	602007	.47		
244055	.18, 30	602008	.47		
244056	.30	602009	.47		
244057	.30	602012	.50		
244058	.18, 30	602013	.50		
246002	.15, 16	602016	.50		
246372	.23	602017	.50		
247235	.7	602103	.51		
247616	.11, 38	602104	.47		
247770	.47	602106	.47		
247771	.47	602108	.47		
247772	.47	602109	.47		
247773	.47	602112	.49		
247774	.52	602113	.49		
247775	.48	602116	.49		
247776	.48	602117	.49		
247778	.48	602134	.48		
247780	.49	602136	.48		
247782	.47	602138	.48		
247783	.47	602142	.48		
247784	.48	602203	.52		
247786	.48	602204	.48		